

**BRONZE
VALVES**



BR 118 - BRONZE BALL VALVE - PN 25 4
 BR 120 - BRONZE BALL VALVE - 600 PSI 5
 BR 220 - BRONZE STRAINER 6
 BR 325 - BRONZE CHECK VALVE 7
 BR 432 - BRONZE GLOBE VALVE 8
 BR 516 - BRONZE GATE VALVE - PN 16 9
 BR 520 - BRONZE GATE VALVE - PN 20 10
 BR 525 - BRONZE GATE VALVE - PN 25 11
 BR 582 - BRONZE GATE VALVE - PN 32 12
 BR 825 - BRONZE FIXED ORIFICE DRV 13
 VALVE INSTALATION TIPS 14

**BRASS
VALVES**



BS 135 - BRASS BALL VALVE 16
 BS 202 - BRASS STRAINER 17
 BS 302 - BRASS CHECK VALVE 18
 BS 502 - BRASS GATE VALVE 19
 BS 910 - BRASS AIR VENT 20

**CAST-IRON
VALVES**



G101 - DI BUTTERFLY VALVE LEVER 22
 G103 - DI BUTTERFLY VALVE GEAR 23
 G201 - CI Y STRAINER CL 125 24
 G203 - CI Y STRAINER PN 16 25
 G301 - CI CHECK VALVE CL 125 26
 G303 - CI CHECK VALVE PN 16 27
 G311 - CI WAFER CHECK VALVE 28
 G401 - CI GLOBE VALVE CL 125 29
 G403 - CI GLOBE VALVE PN 16 30
 G501 - CI GATE VALVE NRS CL 125 31
 G503 - CI GATE VALVE NRS PN 16 32
 G505 - CI GATE VALVE OS&Y CL1 25 33
 G507 - CI GATE VALVE OS&Y PN 16 34
 G801 - CI BALANCING VALVE 35



European Casting Industry ECI is dedicated to manufacturing the best quality of wide range valves. Our goal is to provide first class quality and standards to our clients. ECI valves have a wide range of use in the heating, ventilating, and air-conditioning systems, while also being applicable in the oil and gas fields. Each of our products has been systematically tested and monitored to ensure that the standards of quality are being met.











ECI produces the same valves with different standards, this allow better distribution of valves to more areas around the world, particularly in the Middle East, Europe and North America.



Bronze Valves



PAGE

	BR 118 - BRONZE BALL VALVE - PN 25	4
	BR 120 - BRONZE BALL VALVE - 600 PSI	5
	BR 220 - BRONZE STRAINER	6
	BR 325 - BRONZE CHECK VALVE	7
	BR 432 - BRONZE GLOBE VALVE	8
	BR 516 - BRONZE GATE VALVE - PN 16	9
	BR 520 - BRONZE GATE VALVE - PN 20	10
	BR 525 - BRONZE GATE VALVE - PN 25	11
	BR 582 - BRONZE GATE VALVE - PN 32	12
	BR 825 - BRONZE FIXED ORIFICE DOUBLE REGULATING VALVE	13
	Valve Instalation Tips	14

BR 118

BRONZE BALL VALVE

WORKING PRESSURE PN 25

FULL BORE

TAPER PIPE THREADED TO ISO 7

DESIGN STANDARD GB/T8464



www.ecivalve.it

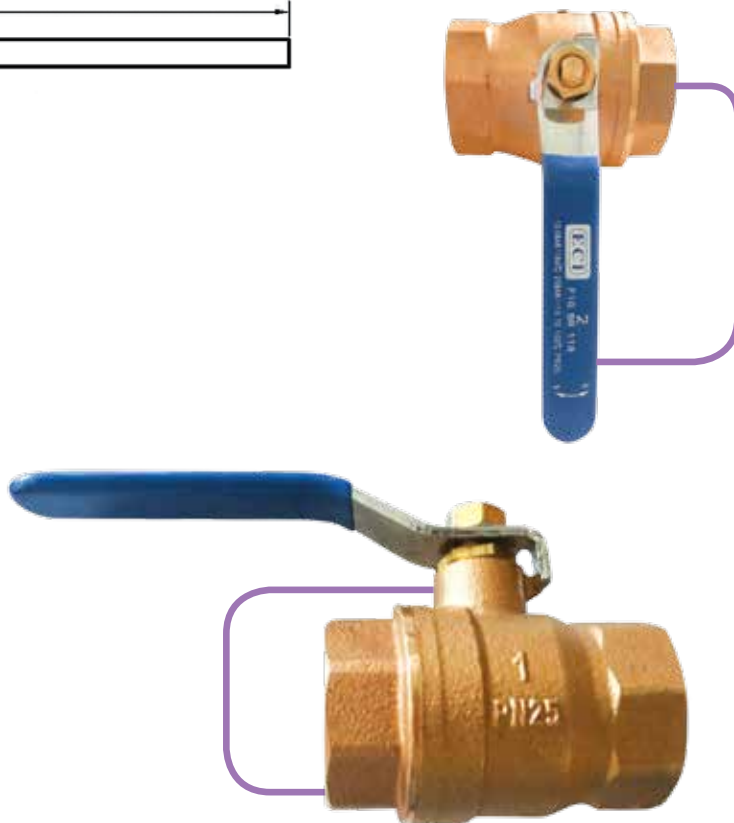
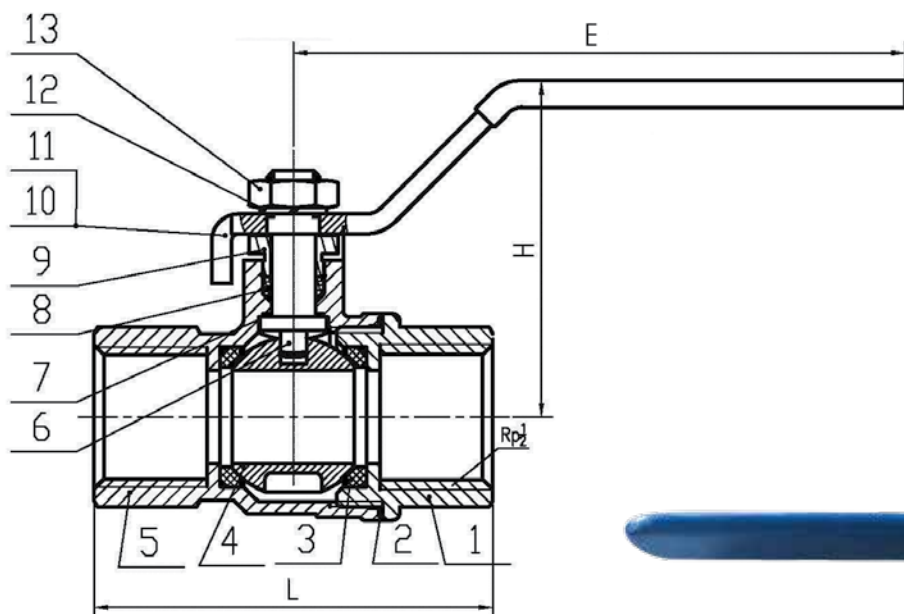

Specifications:

- WORKING PRESSURE:
PN 25
- WORKING TEMPERATURE: $T \leq 170^{\circ}\text{C}$
- PORT SIZE:
 $\frac{1}{2}$ " UP TO 2"
FULL PORT
- TESTING PRESSURE: 100 PSI AIR FOR SHELL & SEAT
- TAPER PIPE THREADED TO NPT AND ISO 7-1 (ex. BS-21)
- SUITABLE MEDIA: WATER, OIL, AIR, STEAM & GAS

Dimensions (mm)

DN	SIZE INCH	L	H	E	WEIGHT KGS
15	$\frac{1}{2}$ "	53	44	95	0.228
20	$\frac{3}{4}$ "	61	51	110	0.366
25	1"	71	55	110	0.539
32	$1\frac{1}{4}$ "	85	65	140	0.838
40	$1\frac{1}{2}$ "	92	70	140	1.133
50	2"	114	83	160	1.880

Material

No.	DESCRIPTION	MATERIAL
1	SEAT RETAINER	BRONZE CC491K
2	PACKING	PTFE
3	SEAT	PTFE
4	BALL	BRASS CW617N
5	BODY	BRONZE CC491K
6	STEM	DZR BRASS CW602N
7	STEM GASKET	PTFE
8	PACKING	PTFE
9	GLAND NUT	BRASS CW617N
10	LEVER	MILD STEEL CHROME PLATED
11	LEVER COVER	PVC
12	WASHER	STAINLESS STEEL
13	NUT	STAINLESS STEEL



All data, descriptions and pictures contained in this leaflet may be subject to change without prior notice.

European Casting Industry Srl | Via D'Azeglio 57 | 40123 Bologna BO, Italia | P.Iva: 03228761205 | www.ecivalve.it | info@ecivalve.it

BR 120

BRONZE BALL VALVE

600 PSI / 41.4 BAR WOG

150 PSI / 10.3 BAR WSP

1/2"~1" FULL PORT

1 1/4"~4" CONVENTIONAL PORT

CONFORMS TO MSS SP-110

ECI EUROPEAN
CASTING
INDUSTRY

www.ecivalve.it

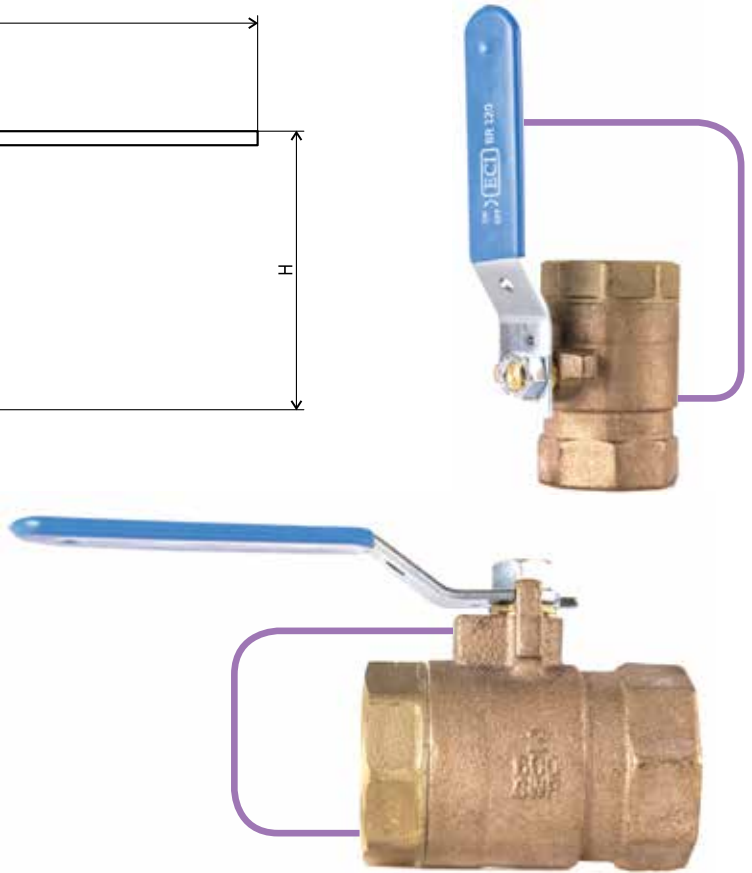
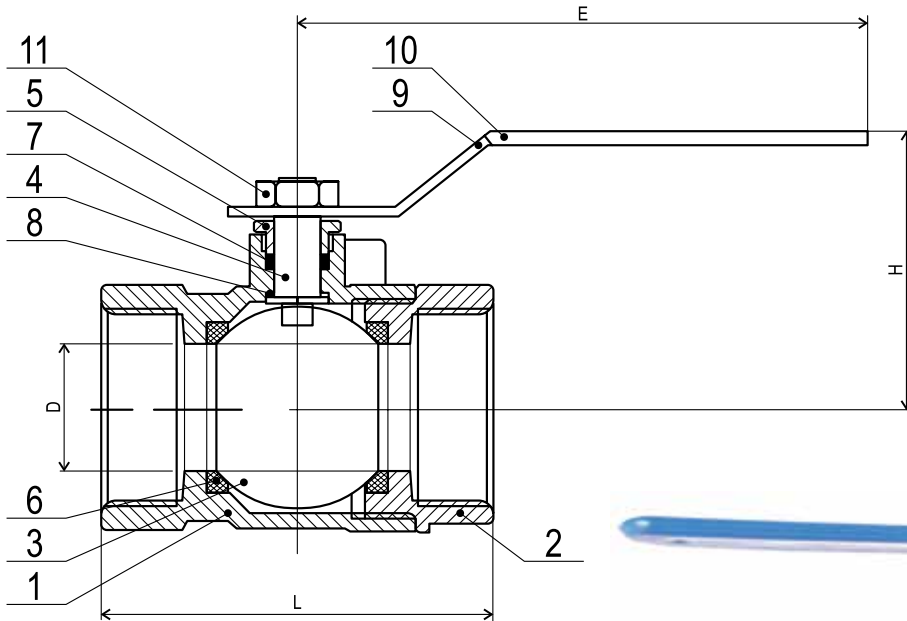

Specifications:

- WORKING PRESSURE:
600 PSI / 41.4 BAR WOG
150 PSI / 10.3 BAR WSP
- WORKING TEMPERATURE: $T \leq 140^{\circ}\text{C}$
- PORT SIZE:
1/2"~1" FULL PORT
1 1/4"~4" RED PORT (CONVENTIONAL)
- TESTING PRESSURE: 100 PSI AIR FOR SHELL & SEAT
- TAPER PIPE THREADED TO NPT AND ISO 7-1 (ex. BS-21)
- SUITABLE MEDIA: WATER, OIL, AIR & STEAM

Dimensions (mm)

DN	SIZE INCH	L	H	E	WEIGHT KGS
15	1/2"	61	48	102	0.399
20	3/4"	74	56	122	0.581
25	1"	86	65	122	0.889
32	1 1/4"	102	69	122	1.406
40	1 1/2"	109	79	175	2.177
50	2"	117	84	175	3.039
65	2 1/2"	150	91	175	3.856
80	3	180	114	201	6.713

Material

No.	DESCRIPTION	BRONZE	LEAD FREE
1	Body	ASTM B584 C84400	ASTM C87850 or C89844
2	Tailpiece	ASTM B584 C84400	ASTM C87850 or C89844
3	Ball	ASTM B16 C36000	Stainless Steel 316
4	Stem	ASTM B16 C36000	ASTM C69300 or CW510L
5	Packing Nut	ASTM B16 C36000	ASTM C69300 or CW510L
6	Ball Seat	15% Glass RPTFE	15% Glass RPTFE
7	Packing	15% Glass RPTFE	15% Glass RPTFE
8	Thrust Washer	15% Glass RPTFE	15% Glass RPTFE
9	Handle	Steel-Zn.P.	Steel-Zn.P.
10	Handle Sleeve	Vinyl	Vinyl
11	Handle Nut	Steel-Zn.P.	Steel-Zn.P.



ECI EUROPEAN
CASTING
INDUSTRY

All data, descriptions and pictures contained in this leaflet may be subject to change without prior notice.

European Casting Industry Srl | Via D'Azeglio 57 | 40123 Bologna BO, Italia | P.Iva: 03228761205 | www.ecivalve.it | info@ecivalve.it

BR 220

BRONZE STRAINER

PN 20 "Y" TYPE



www.ecivalve.it

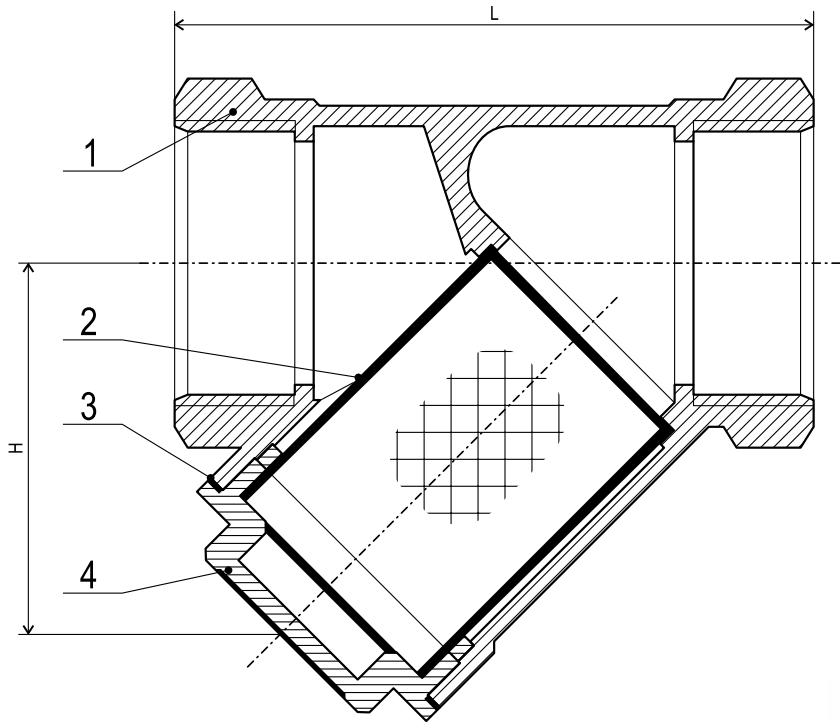

Specifications:

- PRESSURE RATING: PN 20
- SUITABLE MEDIA: WATER, OIL, AIR & GAS
- WORKING TEMPERATURE: $T \leq 170^{\circ}\text{C}$
- TAPER PIPE THREAD TO NPT AND ISO 7-1 (EX. BS-21)

Dimensions (mm)

DN	SIZE INCH	L	H	WEIGHT KGS
15	1/2"	58	33	0.185
20	3/4"	70	41	0.298
25	1"	88	49	0.426
32	1 1/4"	96	56	0.720
40	1 1/2"	107	62	0.980
50	2"	126	80	1.500

Material

No.	DESCRIPTION	MATERIAL
1	Body	Bronze CC491K
2	Screen	Stainless Steel Type 304
3	Gasket	P.T.F.E
4	Cap	Bronze CC491K



All data, descriptions and pictures contained in this leaflet may be subject to change without prior notice.

European Casting Industry Srl | Via D'Azeglio 57 | 40123 Bologna BO, Italia | P.Iva: 03228761205 | www.ecivalve.it | info@ecivalve.it

BR 325

BRONZE CHECK VALVE

PN 25 SWING TYPE

CONFORMS TO MSS SP-80



www.ecivalve.it

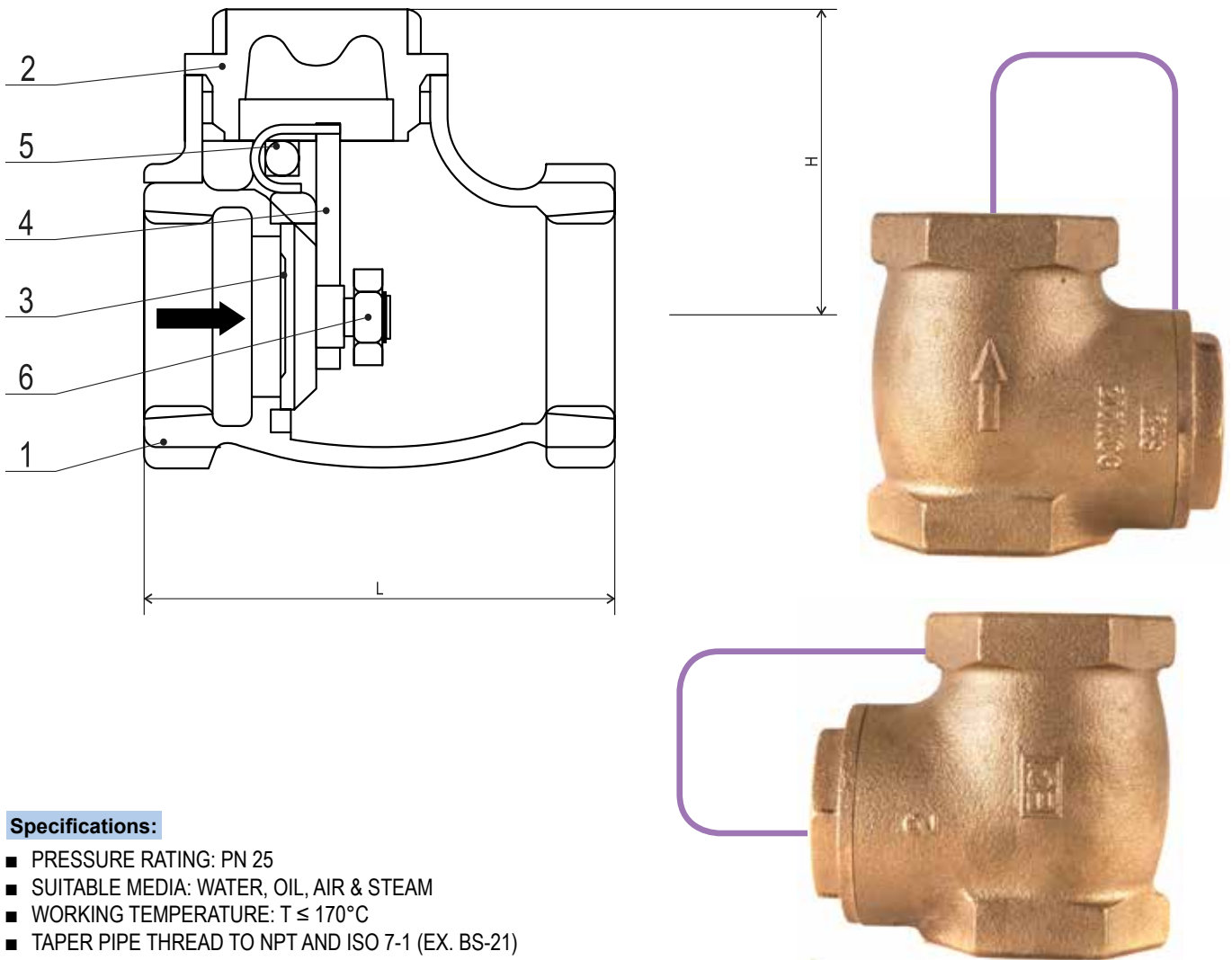

Specifications:

- PRESSURE RATING: PN 25
- SUITABLE MEDIA: WATER, OIL, AIR & STEAM
- WORKING TEMPERATURE: $T \leq 170^{\circ}\text{C}$
- TAPER PIPE THREAD TO NPT AND ISO 7-1 (EX. BS-21)

Dimensions (mm)

DN	SIZE INCH	L	H	WEIGHT KGS
10	3/8"	48	33	0.301
15	1/2"	58	38	0.332
20	3/4"	66	42	0.440
25	1"	80	49	0.687
32	1 1/4"	89	56	1.010
40	1 1/2"	95	65	1.423
50	2"	108	76	2.390

Material

No.	DESCRIPTION	MATERIAL
1	Body	Bronze CC491K
2	Cap	Bronze CC491K
3	Disc	Bronze CC491K (1.1/4" - 2")
3	Disc	Brass CW617N (3/8" - 1")
4	Hinge	Bronze CC491K
5	Hinge Pin	Stainless Steel
6	Hinge Nut	Brass CW617N



All data, descriptions and pictures contained in this leaflet may be subject to change without prior notice.

European Casting Industry Srl | Via D'Azeglio 57 | 40123 Bologna BO, Italia | P.Iva: 03228761205 | www.ecivalve.it | info@ecivalve.it

BR 432

BRONZE GLOBE VALVE

PN 32

RISING STEM

CONFORMS TO BS 5154/MSS SP-80



www.ecivalve.it

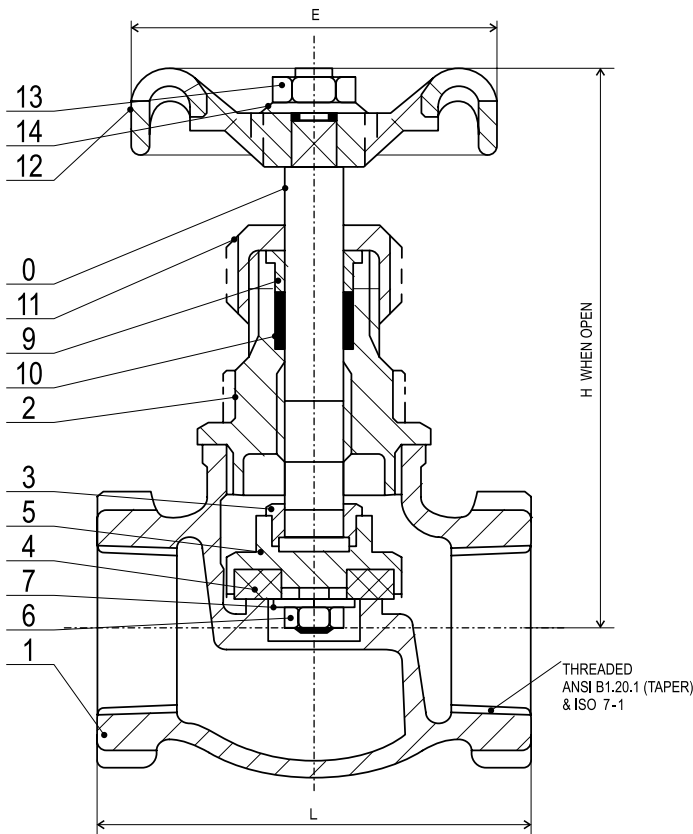

Specifications:

- PRESSURE RATING: PN 32
- SUITABLE MEDIA: WATER, OIL, AIR & STEAM
- WORKING TEMPERATURE: T ≤ 180°C
- TAPER PIPE THREAD TO NPT AND ISO 7-1 (EX. BS-21)

Dimensions (mm)

DN	SIZE INCH	L	H	E	WEIGHT KGS
15	1/2"	62	101	52	0.540
20	3/4"	74	115	52	0.650
25	1"	90	125	70	0.810
32	1 1/4"	100	150	70	1.550
40	1 1/2"	115	159	92	2.010
50	2"	136	191	103	3.080

Material

No.	DESCRIPTION	MATERIAL
1	Body	Bronze CC491K
2	Bonnet	Bronze CC491K
3	Disc Stem Ring	Brass CW602N
4	Disc	P.T.F.E
5	Disc Holder	Bronze CC491K
6	Disc Nut	Brass CW602N
7	Washer	Brass CW602N
8	Stem	Brass CW602N
9	Gland	Brass CW614N
10	Packing	Asbestos Free
11	Packing Nut	Brass CW614N
12	Handwheel	Aluminum
13	Handwheel Nut	Brass CW614N
14	I.D Plate	Aluminum



All data, descriptions and pictures contained in this leaflet may be subject to change without prior notice.

European Casting Industry Srl | Via D'Azeglio 57 | 40123 Bologna BO, Italia | P.Iva: 03228761205 | www.ecivalve.it | info@ecivalve.it

BR 516

BRONZE GATE VALVE

PN 16

NON-RISING STEM

CONFORMS TO PED 97/23/CE

& IT IS CE MARKING-FREE AS PER ART. 3 PAR.3



www.ecivalve.it

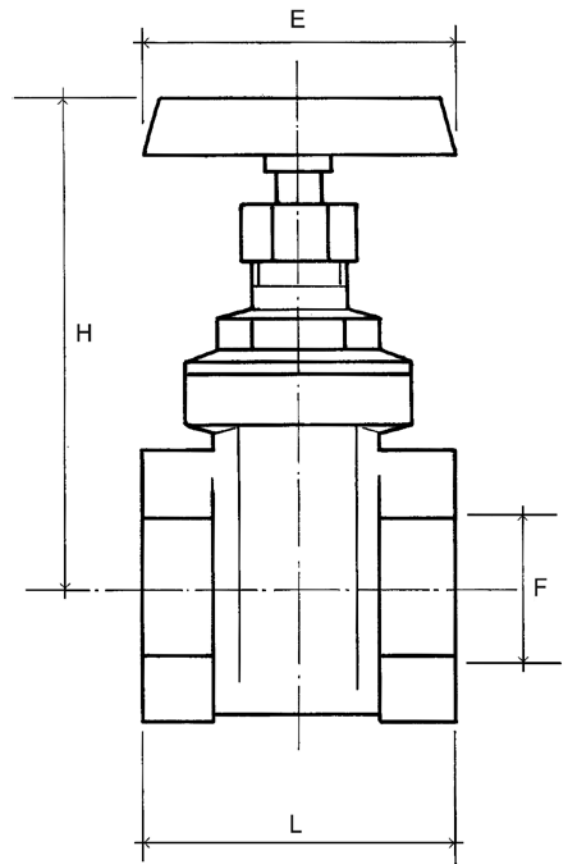

Specifications:

- PRESSURE RATING: PN 16
- SUITABLE MEDIA: WATER, OIL & AIR
- WORKING TEMPERATURE: $T \leq 80^{\circ}\text{C}$
- TAPER PIPE THREAD TO NPT AND ISO 228/1

Dimensions (mm)

DN	SIZE INCH	F	L	H	E	WEIGHT KGS
15	1/2"	15	38	68	45	0.195
20	3/4"	19	45	78	50	0.280
25	1"	24	48	92	55	0.380
32	1 1/4"	32	51	108	60	0.600
40	1 1/2"	37	58	125	70	0.830
50	2"	47	62	145	80	1.210

Material

DESCRIPTION	MATERIAL
Body	Bronze SN 5 UNI-EN1982 DIN50930/6
Bonnet	Brass CW 617 N-UNI-EN12165
Stem	Brass CW 614 N-UNI-EN12164
Packing	EPDM90 DUTRAL
Wedge	Brass DELTA CS UNI-EN1982 CB 7535
Handwheel	Steel with blue plastic coating
Handwheel Nut	Steel Zinc plated

TUV APPROVED ART.210-RASTELLI



All data, descriptions and pictures contained in this leaflet may be subject to change without prior notice.

European Casting Industry Srl | Via D'Azeglio 57 | 40123 Bologna BO, Italia | P.Iva: 03228761205 | www.ecivalve.it | info@ecivalve.it

BR 520

BRONZE GATE VALVE

PN 20

NON-RISING STEM

CONFORMS TO BS 5154

ECI EUROPEAN
CASTING
INDUSTRY

www.ecivalve.it

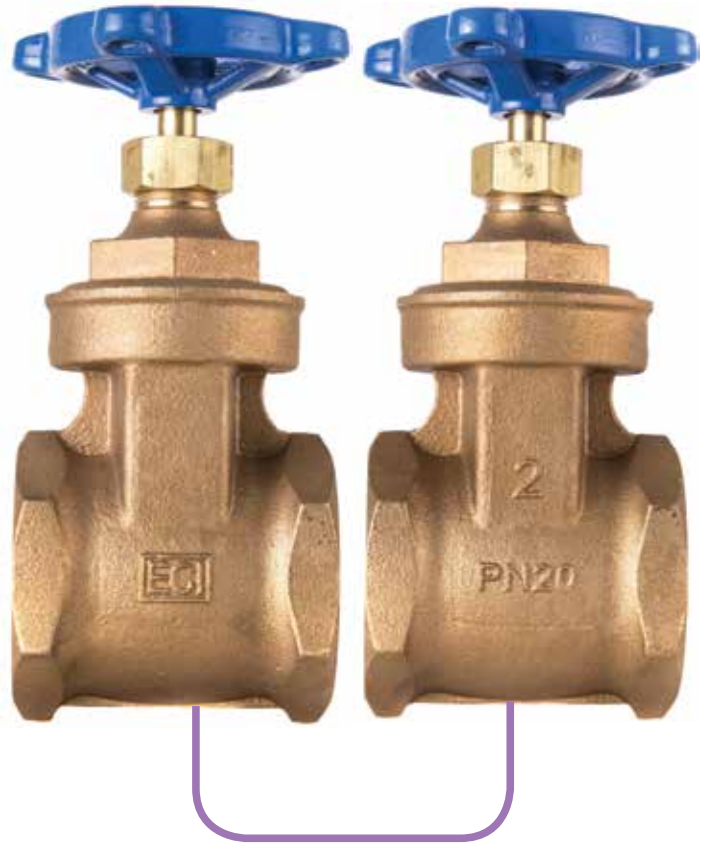
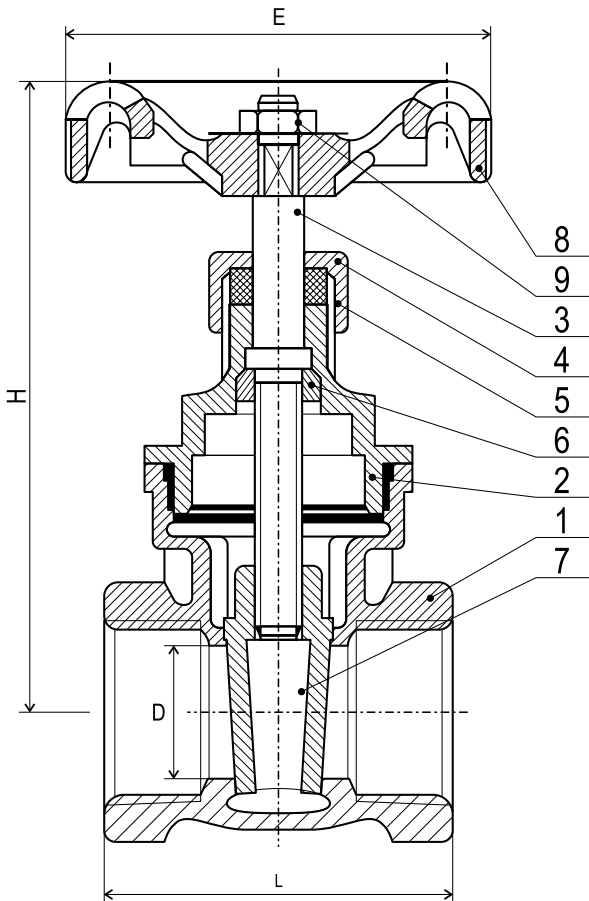

Specifications:

- PRESSURE RATING: PN 20
- SUITABLE MEDIA: WATER, OIL, AIR & STEAM
- WORKING TEMPERATURE: $T \leq 170^{\circ}\text{C}$
- TAPER PIPE THREAD TO NPT AND ISO 7-1 (EX. BS-21)

Dimensions (mm)

DN	SIZE INCH	D	L	H	E	WEIGHT KGS
15	1/2"	12.7	50	74	52	0.268
20	3/4"	19.1	54	85	52	0.395
25	1"	25.4	62	106	70	0.585
32	1 1/4"	31.8	70	113	70	0.857
40	1 1/2"	38.2	77	132	92	1.265
50	2"	50.9	87	155	92	1.900

Material

No.	DESCRIPTION	MATERIAL
1	Body	Bronze CC491K
2	Bonnet	Bronze CC491K
3	Stem	DZR Brass CW602N
4	Packing Nut	Brass CW617N
5	Packing	P.T.F.E
6	Stem Bush	DZR Brass CW602N
7	Disc	Bronze CC491K
8	Handwheel	Aluminum
9	Handwheel Nut	Brass CW614N

ECI EUROPEAN
CASTING
INDUSTRY

All data, descriptions and pictures contained in this leaflet may be subject to change without prior notice.

European Casting Industry Srl | Via D'Azeglio 57 | 40123 Bologna BO, Italia | P.Iva: 03228761205 | www.ecivalve.it | info@ecivalve.it

BR 525

BRONZE GATE VALVE

PN 25

NON-RISING STEM

CONFORMS TO BS 5154/MSS SP-80



www.ecivalve.it

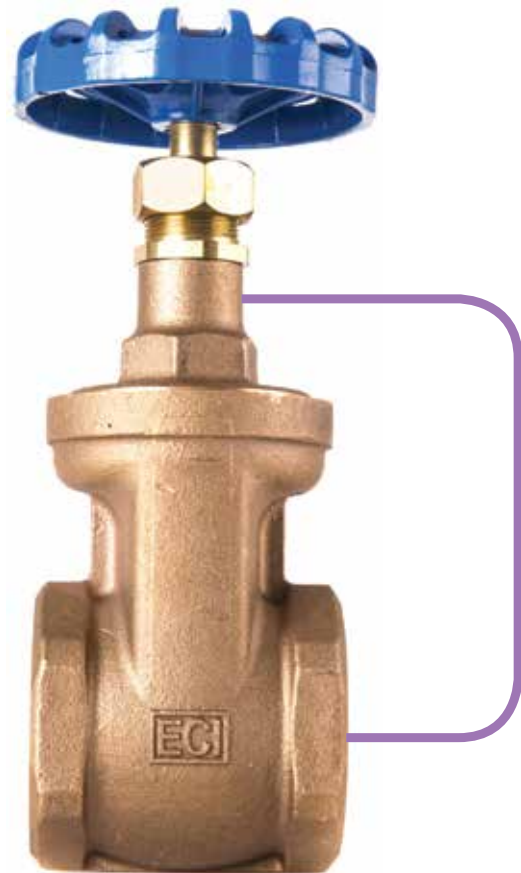
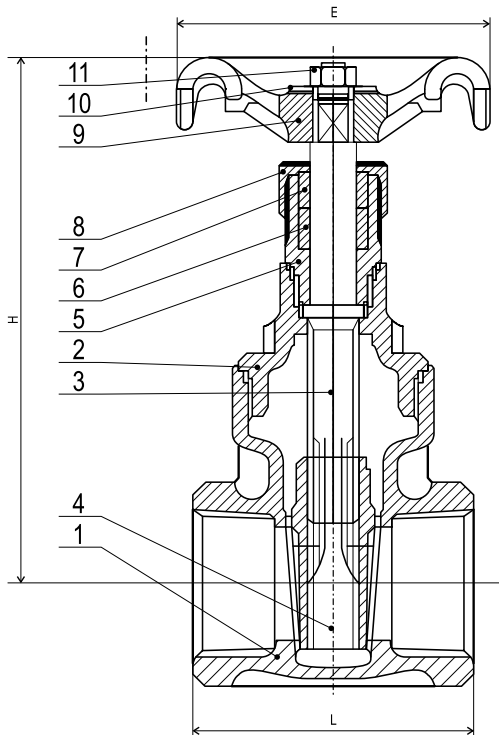

Specifications:

- PRESSURE RATING: PN 25
- SUITABLE MEDIA: WATER, OIL, AIR & STEAM
- WORKING TEMPERATURE: $T \leq 170^{\circ}\text{C}$
- TAPER THREAD TO NPT AND ISO 7-1 (EX. BS-21)

Dimensions (mm)

DN	SIZE INCH	L	H	E	WEIGHT KGS
8	1/4"	46	75	45	0.284
10	3/8"	46	75	45	0.268
15	1/2"	51	82	52	0.341
20	3/4"	55	95	65	0.582
25	1"	63	118	70	0.878
32	1 1/4"	71	144	79	1.360
40	1 1/2"	73	166	92	1.750
50	2"	83	190	103	2.810

Material

No.	DESCRIPTION	MATERIAL
1	Body	Bronze CC491K
2	Bonnet	Bronze CC491K
3	Stem	DZR Brass CW602N
4	Disc	Bronze CC491K
5	Stuffing Box	DZR Brass CW602N
6	Packing Ring	P.T.F.E
7	Gland	Brass CW614N
8	Packing Nut	Brass CW614N
9	Handwheel	Aluminum
10	Identification Plate	Aluminum
11	Handwheel Nut	Brass CW614N



All data, descriptions and pictures contained in this leaflet may be subject to change without prior notice.

European Casting Industry Srl | Via D'Azeglio 57 | 40123 Bologna BO, Italia | P.Iva: 03228761205 | www.ecivalve.it | info@ecivalve.it

BR 582

BRONZE GATE VALVE

PN 32

RISING STEM

CONFORMS TO BS 5154/MSS SP-80

ECI EUROPEAN
CASTING
INDUSTRY

www.ecivalve.it

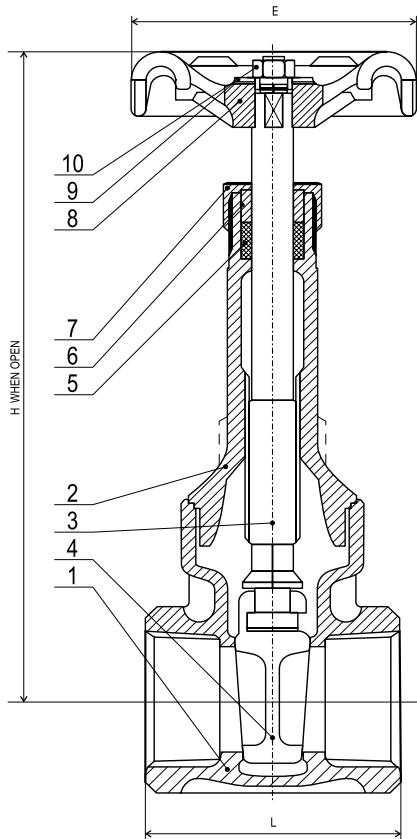

Specifications:

- PRESSURE RATING: PN 32
- SUITABLE MEDIA: WATER, OIL, AIR & STEAM
- WORKING TEMPERATURE: $T \leq 170^{\circ}\text{C}$
- TAPER PIPE THREAD TO NPT AND ISO 7-1 (EX. BS-21)

Dimensions (mm)

DN	SIZE INCH	L	H	E	WEIGHT KGS
8	1/4"	46	126	45	0.320
10	3/8"	46	126	45	0.310
15	1/2"	51	129	52	0.400
20	3/4"	55	159	65	0.643
25	1"	63	189	70	0.998
32	1 1/4"	72	219	78	1.519
40	1 1/2"	73	246	92	2.064
50	2"	83	301	92	3.191
65	2 1/2"	108	369	134	5.800
80	3"	117	416	134	8.520

Material

No.	DESCRIPTION	MATERIAL
1	Body	Bronze CC491K
2	Bonnet	Bronze CC491K
3	Stem	Bronze CC491K
4	Disc	Bronze CC491K
5	Packing	P.T.F.E
6	Clamping Ring	Brass CW614N
7	Packing Nut	Brass CW614N
8	Handwheel	Aluminum
9	Id Plate	Aluminum
10	Handwheel Nut	Brass CW614N

ECI EUROPEAN
CASTING
INDUSTRY

All data, descriptions and pictures contained in this leaflet may be subject to change without prior notice.

European Casting Industry Srl | Via D'Azeglio 57 | 40123 Bologna BO, Italia | P.Iva: 03228761205 | www.ecivalve.it | info@ecivalve.it

BR 825

BRONZE FIXED ORIFICE
DOUBLE REGULATING VALVE (DRV)

PN 25

CONFORMS TO BS7350



ECI EUROPEAN
CASTING
INDUSTRY

www.ecivalve.it

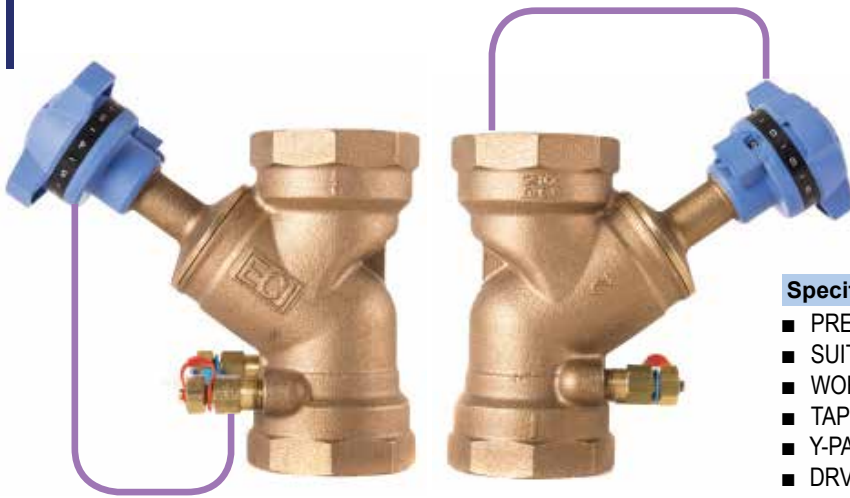

Specifications:

- PRESSURE RATING: PN 25
- SUITABLE MEDIUM: WATER
- WORKING TEMPERATURE: $T \leq 120^{\circ}\text{C}$
- TAPER PIPE THREAD TO ISO 7-1 (EX. BS-21)
- Y-PATTERN GLOBE VALVE WITH THROTTLING DISC
- DRV WITH A FIXED ORIFICE DESIGN
- ACCURACY $\pm 5\%$ ON ALL SETTINGS
- DRV ALLOWS VALVE OPENING TO BE SET WITH ALLEN KEY.
- DRV HAS A MICROSET HAND WHEEL
- FOR USE IN HVAC & PLUMBING SYSTEMS
- TO BE USED FOR ISOLATING & TO BE RE-OPENED TO ITS PRE-SET POSITION
- SUPPLIED WITH TWO TEST POINTS
- DESIGN AND MANUFACTURE CONFORM TO BS7350

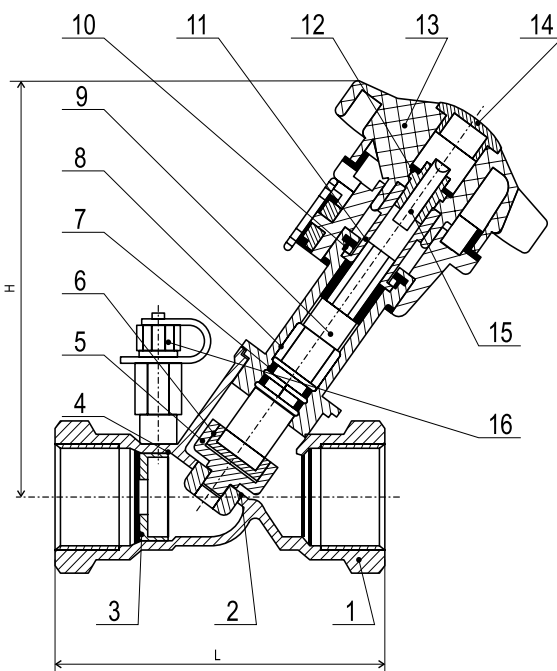

Material

No.	DESCRIPTION	MATERIAL	SIZES
1	Body	Bronze CC491K	All
2	Disc Face	P.T.F.E	1"-2"
2	Disc Face	DZR Brass CW602N	1/2"-3/4"
3	Orifice Plate	DZR Brass CW602N	All
4	Nut	DZR Brass CW602N	All
5	Disc	DZR Brass CW602N	All
6	Disc Retaining Ring	DZR Brass CW602N	All
7	O Ring	N.B.R	All
8	Bonnet	DZR Brass CW602N	1/2"-1 1/4"
8	Bonnet	Bronze CC491K	1 1/2"-2"
9	Stem	DZR Brass CW602N	All
10	Retainer Ring	Stainless Steel 304	All
11	Sleeve	Brass CW617N	All
12	Screw	Brass CW614N	All
13	Handwheel	PA	All
14	Cap	PA	All
15	Screw	Stainless Steel 304	All
16	Test Points	DZR Brass CW602N	All

Dimensions (mm) & Coefficients

DN	SIZE INCH	L	H	FLOW (KV)	KVS	WEIGHT KGS
15	1/2"	87	105	1.72	2.2	0.580
20	3/4"	96	106	2.97	4.6	0.650
25	1	100	127	4.75	8.5	0.890
32	1 1/4"	114	128	10.25	16.7	1.110
40	1 1/2"	125	143	16.83	26.1	1.460
50	2"	146	144	27.26	43.2	1.980



All data, descriptions and pictures contained in this leaflet may be subject to change without prior notice.

European Casting Industry Srl | Via D'Azeglio 57 | 40123 Bologna BO, Italia | P.Iva: 03228761205 | www.ecivalve.it | info@ecivalve.it

Valve Installation Tips

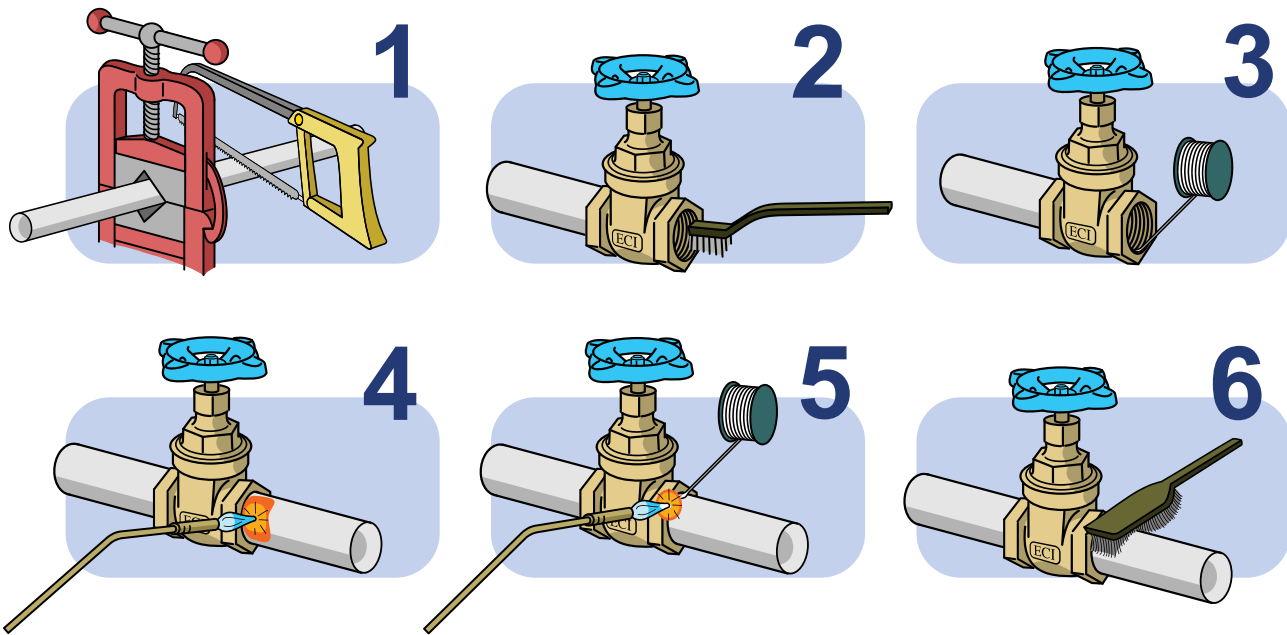

Soldering and Silver Brazing

The most important thing to consider is choosing the correct valve best suited for the application needed. Soldering and silver brazing is the most common method to joining the Bronze valves to tubes or fittings. Poor quality installation can lead to poor and damaged joints. This will lead to leakage and the damaging of the valve.

Perform the following steps to ensure a proper installation:

- 1 Start by cutting the tube end square, use either a tube cutter or a hack saw. Ream, burr and size the tube according to valve size.
- 2 Clean both ends of the cut tube, use a sand cloth or steel wire brush or even a nylon abrasive pad. It is important to eliminate all oxides and any soil from the tube ends to ensure a clean flow through the tubes.
- 3 Apply flux on the outside of the tube ends and the inside of the solder cups. It is best to use a soldering flux that can dissolve and remove any remaining drops of oxide and surface soil from the cleaned surfaces to be joined. It is important that the surface that will be joined to be completely covered in a thin layer of flux.
- 4 Make sure the valve is fully open. Start by applying heat to the tube ends first. Use the tube then to transfer the heat to the valve ends. When using the Silver Brazing Method assemble the part to be brazed. Assemble the tube with the valve ends so that they are joined. It should be noted that the assembly should be firmly supported, and that there can be no change in alignment once the brazing operations starts. Apply flame using a torch to the valve ends. Heat uniformly around the end, moving from valve end to the tube end. Perform heating until noise from heating the flux is gone. For valves that are one-inch and larger it is difficult to raise the temperature around the entire joint to the same temperature. It is recommended to use a double tip torch to allow a uniform temperature around a larger area. A desirable method is using an oxy-acetylene flame. Make sure that the flame is at least 1 inch away from the valve end. Apply heat uniformly on to the valve. Make sure the flame does not remain on any one point. Overheating the valve ends can lead to a damaged valve.
- 5 For the wire use a $\frac{1}{2}$ " solder for a $\frac{1}{2}$ " valve, increase wire size as the size of the valve increases. Excess use of solder can go through the tube and clog the sealing area. A constant run of solder or brazing alloy will be present when the joint is filled. When using the Silver Brazing Method feed the brazing alloy into the joint between the tube and the fitting. Add the brazing only when the metals are heated to brazing temperatures. The flame can be moved away from the valve and tube end when the brazing alloy is applied. Move the flame back and forth as the alloy is inserted into the joint. The brazing alloy will diffuse readily into space between tube outer wall and valve socket. After the joint area is filled a continuous rim of brazing alloy will be visible.
- 6 Any flux residue or excess solder should be brushed off. A fillet should be visible around the valve end as it cools.

Silver Brazing Tips

Using different types of brazing materials does not affect how strong the brazing joint is. The strength of the joint depends a lot on the procedure. If the brazing alloy is applied correctly on the outside tube and the valve socket, then the joint will hold.

Threading Connection Tips

Any type of dirt, residue, or soil that go into the valve can highly damage parts of the valve and hinder its effectiveness. When using a threaded pipe connection, clean the threaded area to remove any deposits from it. Use air or steam to thoroughly remove any residue. Applying steam or air through the valve is also a good way to remove unwanted residue that can damage the valve.

Before installation, check line of flow through valve so that valve will function properly. Close valve completely before installation. Apply wrench to hex next to pipe and guard against possible distortion. After installation of valve, support line; a sagging pipe line can distort valve and cause failure.

Flanged Connection Tips

There are several steps to follow to make sure that a flanged joint will be properly assembled. First, clean the joint carefully. Then loosely assemble the joint by putting in the bottom two or three bolts. Then carefully insert the gasket into place. The bottom bolts will help locate the gasket and hold it in position. Then insert the rest of the bolts into place and tighten all of the bolts evenly—not in rotation, but by the cross-over method to load the bolts evenly and eliminate concentrated stresses. The bolts should be checked for tightness after an appropriate interval of use and retightened if necessary.

Brass Valves



PAGE



BS 135 - BRASS BALL VALVE 16



BS 202 - BRASS STRAINER..... 17



BS 302 - BRASS CHECK VALVE 18



BS 502 - BRASS GATE VALVE 19



BS 910 - BRASS AIR VENT 20

BS 135

BRASS BALL VALVE
CHROME PLATED EN 12540
PN 28 & PN 35

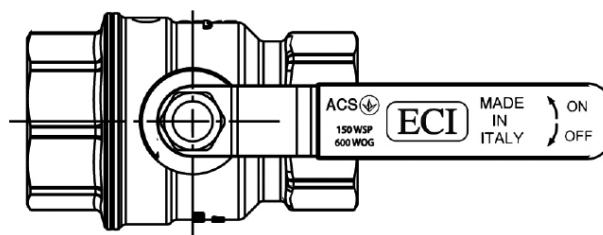
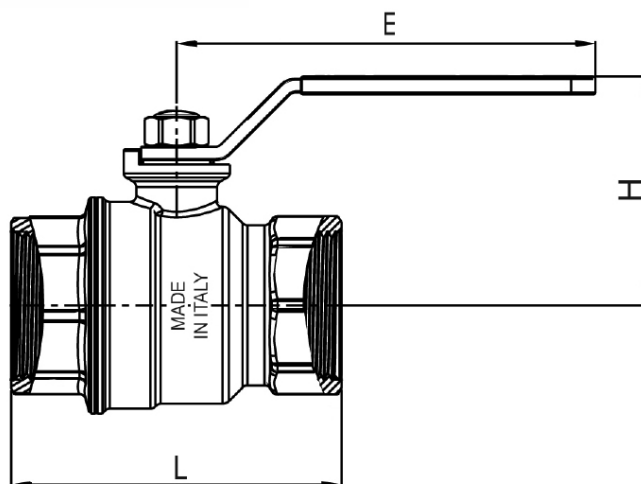

Specifications:

- FULL BORE SIZES 1/2" TO 2"
- STANDARD PASSAGE SIZES 2.1/2" UP TO 4"
- WP: 35 BAR SIZES 1/2" & 3/4"
28 BAR SIZES 1" UP TO 4"
- WORKING TEMPERATURE: T ≤ 140°C
- SUITABLE FOR WATER, GLYCOLATE SOLUTION (GLYCOL 50%)
- THREADED ACCORDING TO ISO 228/1
- SHELL TEST ACCORDING TO UNI EN 13828

Dimensions (mm)

DN	SIZE INCH	L	H	E	WEIGHT KGS
15	1/2"	53	35	77	0.177
20	3/4"	60	47	95	0.274
25	1"	74	51	95	0.407
32	1 1/4"	84	56	95	0.565
40	1 1/2"	95	69	137	0.984
50	2"	109	77	137	1.539
65	2 1/2"	146	102	173	2.980
80	3"	160	109	173	4.172
100	4"	207	200	187	7.004

Material

DESCRIPTION	MATERIAL
Body	Brass chrome plated EN 12540
Tailpiece	Brass chrome plated EN 12540
Ball	Brass chrome plated EN 12540
Stem	Brass EN 12164-CW614N
Ball Seat	PTFE
Packing	PTFE
Handle	Galvanized steel
Handle Sleeve	Vinyl
Handle Nut	Galvanized steel



All data, descriptions and pictures contained in this leaflet may be subject to change without prior notice.

European Casting Industry Srl | Via D'Azeglio 57 | 40123 Bologna BO, Italia | P.Iva: 03228761205 | www.ecivalve.it | info@ecivalve.it

BS 202

BRASS STRAINER "Y" TYPE
 ACCORDING TO PED 97/23/CE
 AND IT IS CE MARKING-FREE
 AS PER ART. 3 PAR. 3
 PN 20

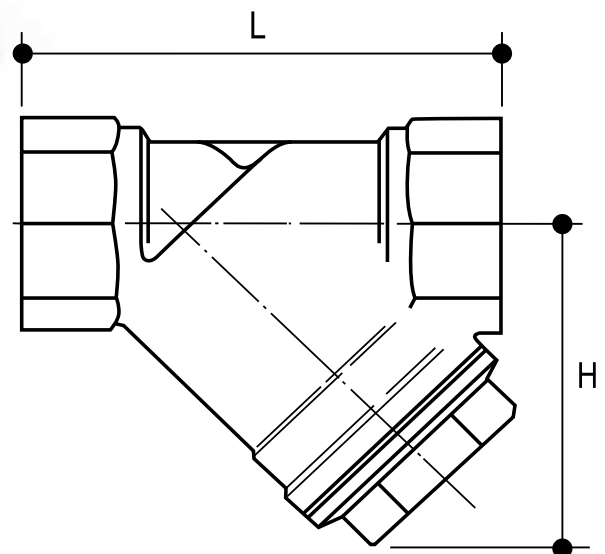
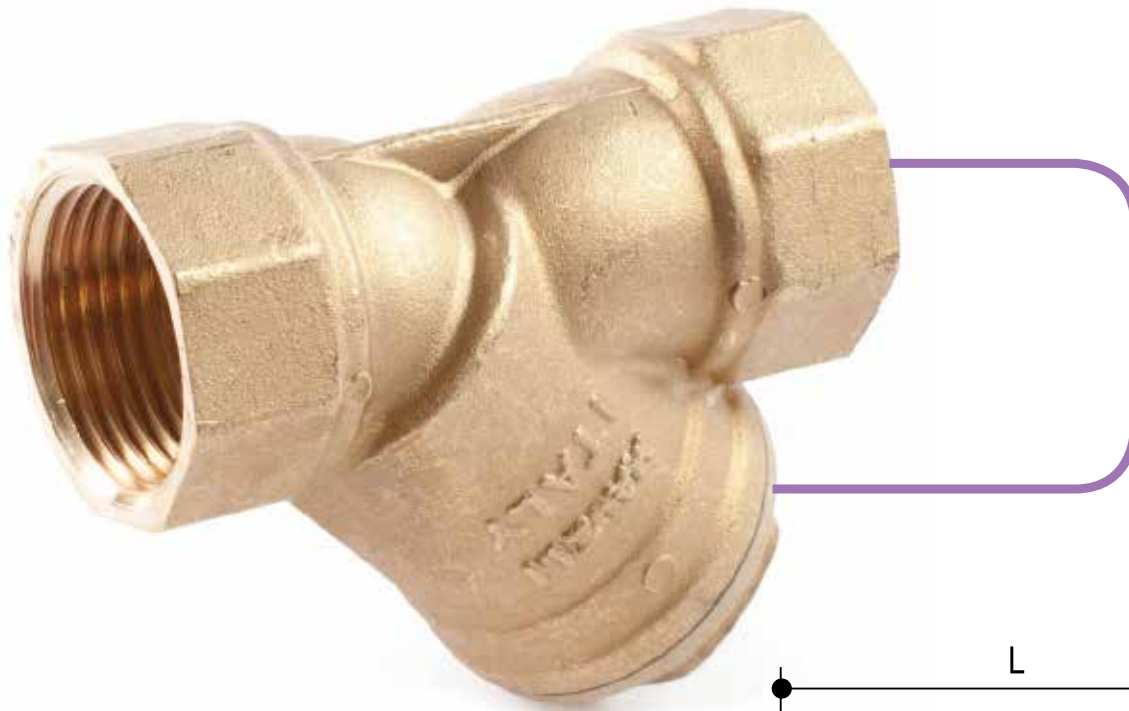

Specifications:

- PN 20 FOR SIZES FROM 1/2" UP TO 2"
- PN 16 FOR SIZES 2.1/2" & 3"
- WORKING TEMPERATURE: T ≤ 80°C
- THREADED ACCORDING TO ISO 228/1
- SUITABLE MEDIA: WATER, OIL & AIR

Dimensions (mm)

DN	SIZE INCH	L	H	WEIGHT KGS
15	1/2"	58	40	0.150
20	3/4"	70	50	0.330
25	1"	78	58	0.430
32	1 1/4"	96	68	0.600
40	1 1/2"	106	75	0.790
50	2"	126	90	1.290
65	2.1/2"	145	100	2.060
80	3"	165	118	3.030

Material

No.	DESCRIPTION	MATERIAL
1	Body Ø 1/2" to 1" Ø 1.1/4" to 3"	Brass CW617N UNI-EN 12165 Brass DELTA C EN 1982 CB 745S
2	Screen	Stainless Steel Type 304
3	Gasket	P.T.F.E
4	Cap	Brass CW617N UNI-EN 12165

TÜV APPROVED ART.412-RASTELLI



All data, descriptions and pictures contained in this leaflet may be subject to change without prior notice.

European Casting Industry Srl | Via D'Azeglio 57 | 40123 Bologna BO, Italia | P.Iva: 03228761205 | www.ecivalve.it | info@ecivalve.it

BS 302

BRASS CHECK VALVE
SWING TYPE
PN 10

ECI EUROPEAN
CASTING
INDUSTRY

www.ecivalve.it

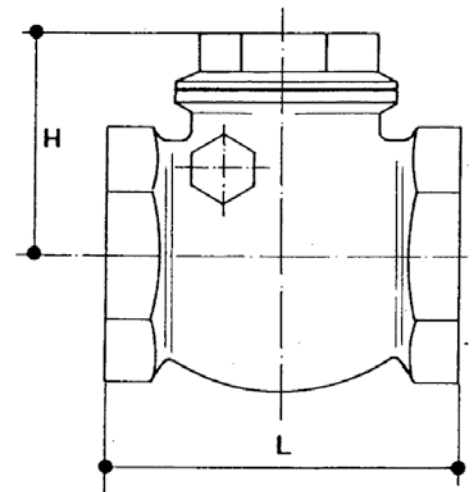
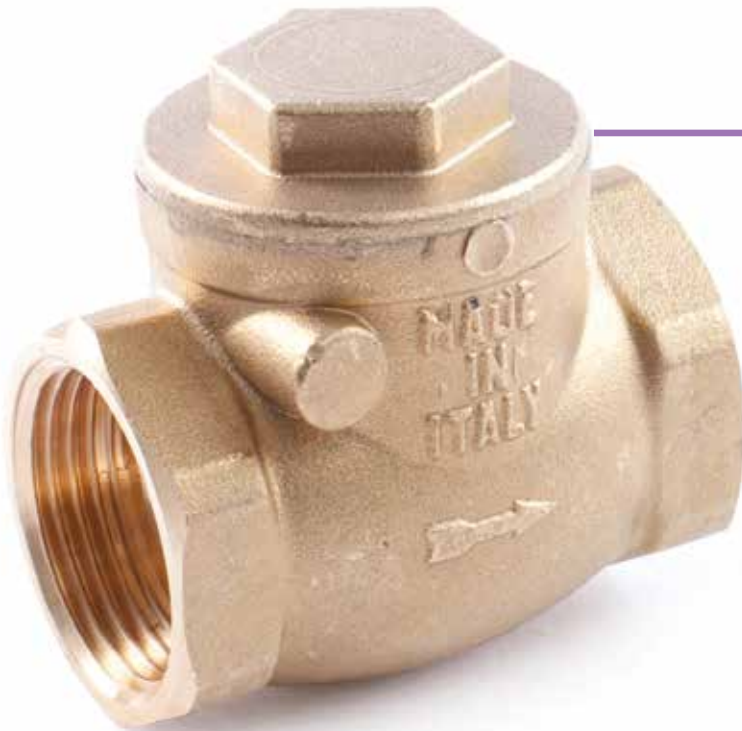

Specifications:

- WORKING PRESSURE: PN 10
- WORKING TEMPERATURE: $T \leq 80^{\circ}\text{C}$
- METAL DISC
- THREADING ACCORDING TO ISO 228/1
- SUITABLE FOR WATER, OIL & AIR

Dimensions (mm)

DN	SIZE INCH	L	H	WEIGHT KGS
15	1/2"	47	24	0.170
20	3/4"	52	26	0.230
25	1"	63	31	0.390
32	1 1/4"	70	37	0.460
40	1 1/2"	84	47	0.730
50	2"	96	50	1.020
65	2 1/2"	116	67	1.590
80	3"	135	76	2.470
100	4"	164	91	3.910

Material

DESCRIPTION	MATERIAL
Body \varnothing 1/2" to 2" \varnothing 2.1/2" to 4"	Brass CW617N UNI-EN 12165 Brass DELTA CS-CB753S UNI-EN1982
Disc	Brass CW617N UNI-EN 12165
Hinge	Brass CW617N UNI-EN 12165
Hinge Pin	Brass CW617N UNI-EN 12165
Hinge Nut	Brass CW617N UNI-EN 12165

ECI EUROPEAN
CASTING
INDUSTRY

All data, descriptions and pictures contained in this leaflet may be subject to change without prior notice.

European Casting Industry Srl | Via D'Azeglio 57 | 40123 Bologna BO, Italia | P.Iva: 03228761205 | www.ecivalve.it | info@ecivalve.it

BS 502

BRASS GATE VALVE

PN 20

NON-RISING STEM

CONFORMS TO PED 97/23/CE

& IT IS CE MARKING-FREE AS PER ART. 3 PAR. 3



www.ecivalve.it

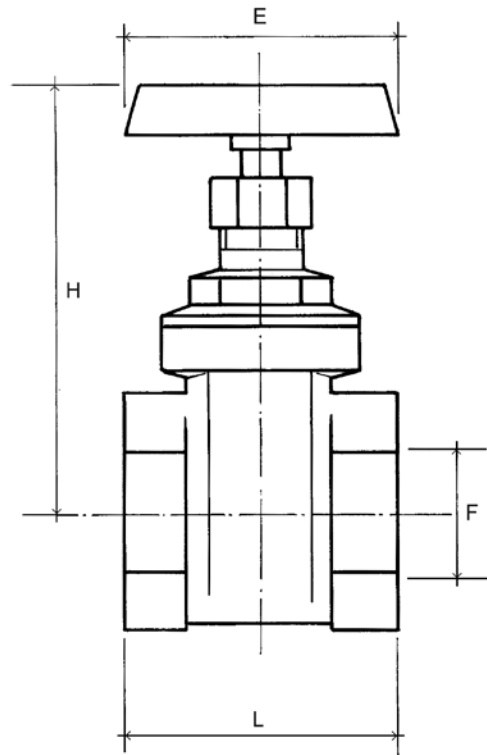
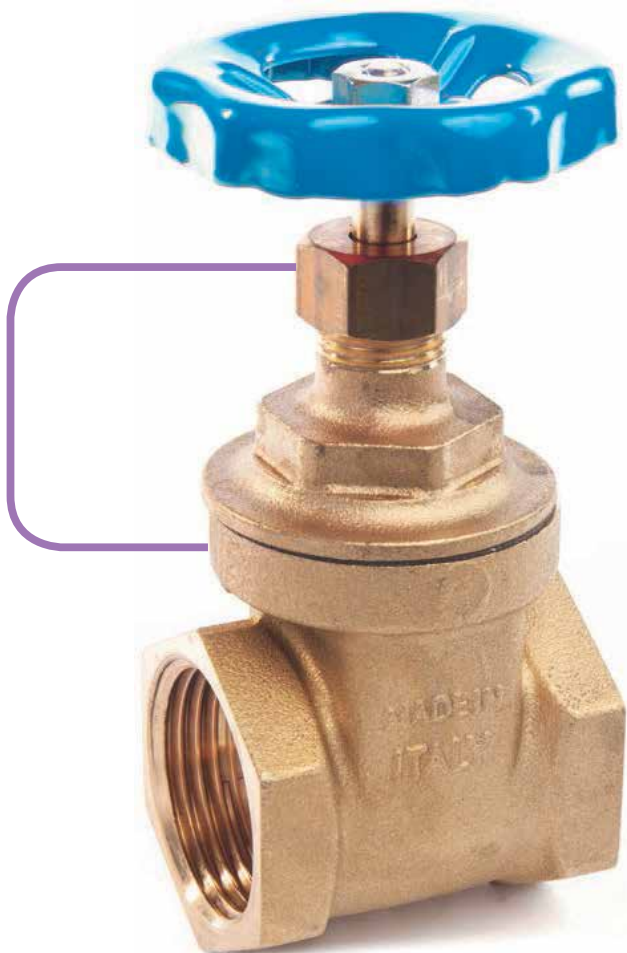

Specifications:

- PRESSURE RATING: PN 20
- SUITABLE MEDIA: WATER, OIL & AIR
- WORKING TEMPERATURE: T ≤ 80°C
- TAPER PIPE THREAD TO NPT AND ISO 228/1

Dimensions (mm)

DN	SIZE INCH	F	L	H	E	WEIGHT KGS
15	1/2"	15	43	68	45	0.200
20	3/4"	19	47	78	50	0.290
25	1"	24	53	92	55	0.400
32	1 1/4"	32	57	108	60	0.620
40	1 1/2"	37	61	125	70	0.750
50	2"	47	67	143	80	1.240
65	2 1/2"	60	74	175	100	1.900
80	3"	72	86	205	100	2.560
100	4"	93	98	235	120	4.640

Material

DESCRIPTION	MATERIAL
Body: Ø up to 2"	Brass CW 617 N-UNI-EN12165
Ø 2 1/2" to 4"	Brass DELTA C EN1982 CB 7545
Bonnet	Brass CW 617 N-UNI-EN12165
Stem & Gland	Brass CW 614 N-UNI-EN12164
Packing	EPDM90 DUTRAL
Wedge	Brass DELTA C EN1982 CB 7545
Handwheel	Steel with blue plastic coating
Handwheel Nut	Steel Zinc plated

TUV APPROVED ART.205-RASTELLI



All data, descriptions and pictures contained in this leaflet may be subject to change without prior notice.

European Casting Industry Srl | Via D'Azeglio 57 | 40123 Bologna BO, Italia | P.Iva: 03228761205 | www.ecivalve.it | info@ecivalve.it

BS 910

BRASS AUTOMATIC AIR VENT

PN 10

ECI EUROPEAN
CASTING
INDUSTRY

www.ecivalve.it

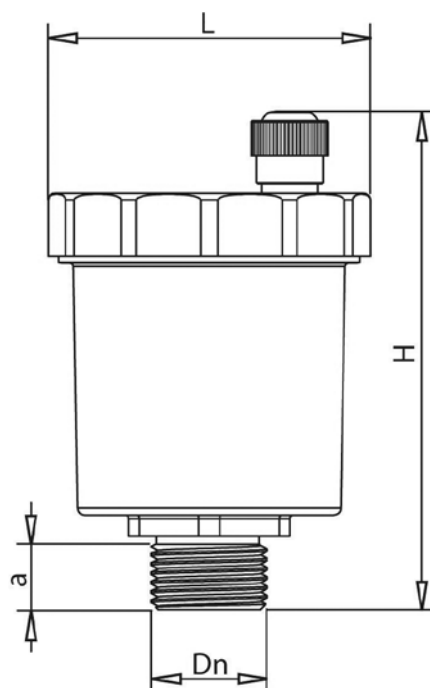

Specifications:

- WORKING PRESSURE: PN 10
- WORKING TEMPERATURE: $T \leq 110^{\circ}\text{C}$
- SINGLE AUTOMATIC FLOAT
- THREADING ACCORDING TO ISO 228/1
- SUITABLE FOR FLUID ACCORDING TO UNI 8065

Dimensions (mm)

DN	SIZE INCH	a	L	H	WEIGHT KGS
10	3/8"	9	46	70	0.146
15	1/2"	9	46	70	0.157
20	3/4"	9	46	70	0.160
25	1"	13	46	70	0.190

Material

DESCRIPTION	MATERIAL
Body	Brass EN 1982-CB754S
Seat	Brass EN 12164-CW617N
Seat Gasket	NBR
Float	Polypropilene PP
Spring	Stainless Steel AISI 302

ECI EUROPEAN
CASTING
INDUSTRY

All data, descriptions and pictures contained in this leaflet may be subject to change without prior notice.

European Casting Industry Srl | Via D'Azeglio 57 | 40123 Bologna BO, Italia | P.Iva: 03228761205 | www.ecivalve.it | info@ecivalve.it

Cast-Iron Valves



G101
DI BUTTERFLY VALVE LEVER .. 22

PAGE



G103
DI BUTTERFLY VALVE GEAR .. 23



G201
CI Y STRAINER CL125 24



G203
CI Y STRAINER PN 16 25



G301
CI CHECK VALVE CL 125 26



G303
CI CHECK VALVE PN 16 27



G311
CI WAFER CHECK VALVE ... 28



G401
CI GLOBE VALVE CL 125 29

PAGE



G403
CI GLOBE VALVE PN 16 30



G501
CI GATE VALVE NRS CL 125. 31



G503
CI GATE VALVE NRS PN 16 . 32



G505
CI GATE VALVE OS&Y CL 125 . 33



G507
CI GATE VALVE OS&Y PN 16 . 34



G801
CI BALANCING VALVE 35

G 101

DUCTILE IRON BUTTERFLY VALVE
 WAFER SEMI-LUGGED TYPE WITH LEVER
 CONFORMS TO MSS SP-67
 CLASS 150 OR PN 16

ECI EUROPEAN
 CASTING
 INDUSTRY

www.ecivalve.it



Specifications:

- WAFER SEMI-LUGGED TYPE BUTTERFLY VALVE WITH LEVER
- END CONNECTION SUITABLE FOR FLANGE
 CONNECTION ANSI B16.5 CLASS 150 OR PN 16
- PRESSURE RATING 150 PSI
- DESIGNED & MANUFACTURED TO MEET MSS SP-67 STANDARD
- NOT SUITABLE FOR STEAM
- SUITABLE MEDIA: FRESH WATER, SEWAGE, SEA WATER, AIR,
 OIL, ACID & CORROSIVE MEDIA
- WORKING TEMPERATURE FROM -15 TO +120°C / -5°F TO +249°F

Dimensions (mm)

DN	H	H1	H2	ød	n-ød	BOLTS	L	WEIGHT KGS
50	273	32	161	121	4-ø19	4 - 5/8" - 11UNC	42.0	2.50
65	296	32	175	140	4-ø19	4 - 5/8" - 11UNC	45.0	3.10
80	308	32	181	153	4-ø19	4 - 5/8" - 11UNC	44.5	3.70
100	346	32	200	191	4-ø19	8 - 5/8" - 11UNC	51.0	5.20
125	372	32	213	216	4-ø22	8 - 3/4" - 10UNC	54.5	6.50
150	397	32	226	242	4-ø22	8 - 3/4" - 10UNC	54.8	8.50
200	480	40	260	299	4-ø22	8 - 3/4" - 10UNC	59.6	14.00
250	545	50	295	362	4-ø25	12 - 7/8" - 9UNC	67.0	21.00
300	634	55	310	432	4-ø25	12 - 7/8" - 9UNC	75.9	32.00

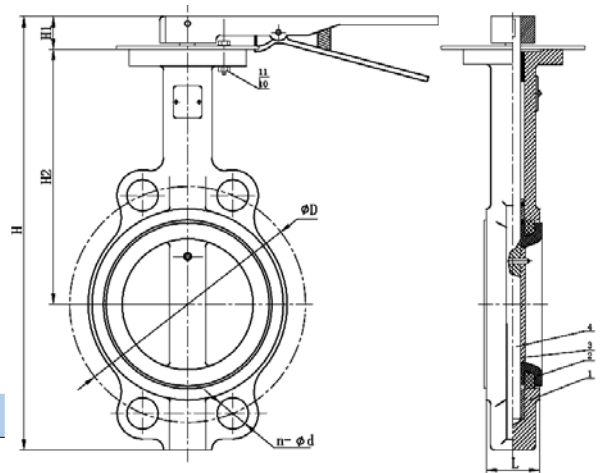

Material

No.	DESCRIPTION	MATERIAL	AMERICAN STANDARD
1	Body	Ductile Iron	ASTM A 536 65-45-12
2	Seat	EPDM	-
3	Disc	Stainless Steel	SS316
4	Shaft	Stainless Steel	SS410

ECI EUROPEAN
 CASTING
 INDUSTRY

All data, descriptions and pictures contained in this leaflet may be subject to change without prior notice.

European Casting Industry Srl | Via D'Azeglio 57 | 40123 Bologna BO, Italia | P.Iva: 03228761205 | www.ecivalve.it | info@ecivalve.it

G 103

DUCTILE IRON BUTTERFLY VALVE
 WAFER SEMI-LUGGED GEAR OPERATED
 CONFORMS TO MSS SP-67
 CLASS 150 OR PN 16

ECI EUROPEAN
 CASTING
 INDUSTRY

www.ecivalve.it



Specifications:

- WAFER SEMI-LUGGED TYPE BUTTERFLY VALVE WITH GEAR OPERATION
- END CONNECTION SUITABLE FOR FLANGE CONNECTION ANSI B16.5 CLASS 150 OR PN 16
- PRESSURE RATING 150 PSI
- DESIGNED & MANUFACTURED TO MEET MSS-SP 67 STANDARD
- NOT SUITABLE FOR STEAM
- SUITABLE MEDIA: FRESH WATER, SEWAGE, SEA WATER, AIR, OIL, ACID & CORROSIVE MEDIA
- WORKING TEMPERATURE FROM -15 TO +120°C / -5°F TO +249°F

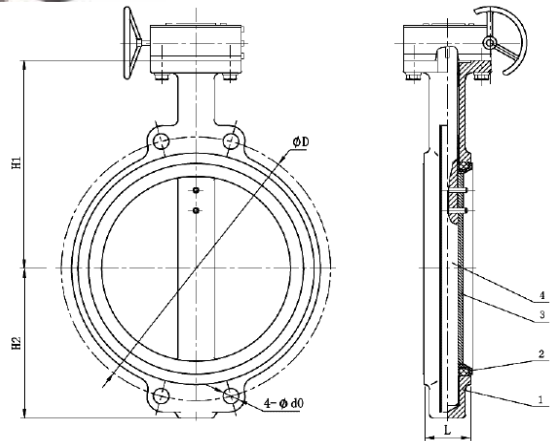

Dimensions (mm)

DN	H1	H2	ød	4-ød	BOLTS	L	WEIGHT KGS
150	226	139	242	4-ø22	8 - 3/4" - 10UNC	54.8	11.50
200	260	175	299	4-ø22	8 - 3/4" - 10UNC	59.6	19.50
250	292	203	362	4-ø25	12 - 7/8" - 9UNC	67.0	25.00
300	337	242	432	4-ø25	12 - 7/8" - 9UNC	75.9	38.00
350	368	267	476	4-ø29	12 - 1" - 8UNC	75.5	44.00
400	400	309	540	4-ø29	16 - 1" - 8UNC	90.0	72.00
450	422	327	578	4-ø32	12 - 1 1/8" - 7UNC	104	85.00

Material

No.	DESCRIPTION	MATERIAL	AMERICAN STANDARD
1	Body	Ductile Iron	ASTM A 395
2	Seat	EPDM	-
3	Disc	Stainless Steel	SS316
4	Shaft	Stainless Steel	SS410

ECI EUROPEAN
 CASTING
 INDUSTRY

All data, descriptions and pictures contained in this leaflet may be subject to change without prior notice.

European Casting Industry Srl | Via D'Azeglio 57 | 40123 Bologna BO, Italia | P.Iva: 03228761205 | www.ecivalve.it | info@ecivalve.it

G 201

CAST IRON STRAINER, Y TYPE
CL-125 FLANGED

ECI EUROPEAN
CASTING
INDUSTRY

www.ecivalve.it

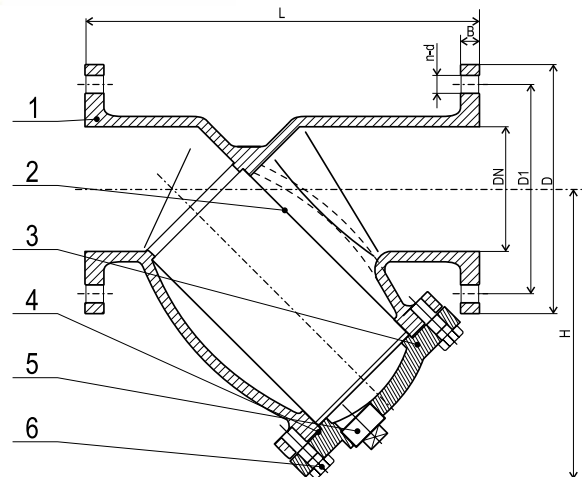

Dimensions (mm)

DN	SIZE INCH	L	D	D1	B	f	n-d	H	WEIGHT KGS
50	2	230	152	121	20	3	4-19	156	10.1
65	2½	290	178	140	20	3	4-19	176	14.0
80	3	310	190	153	22	3	4-19	199	20.3
100	4	350	229	191	24	3	8-19	240	26.6
125	5	400	254	216	26	3	8-22	292	39.8
150	6	480	279	241	26	3	8-22	320	57.0
200	8	600	343	299	30	3	8-22	399	97.0
250	10	730	406	362	32	3	12-25	516	163.5
300	12	850	483	432	32	4	12-25	568	233.5
350	14	980	533	477	36	4	12-29	648	312.0
400	16	1100	597	540	38	4	16-29	759	422.0

Specifications:

- 125 PSI/8.6 BAR SATURATED STEAM TO 353°F/178°C
- 200 PSI/13.8 BAR WOG FROM -10 TO 65 °C
- FLANGE DRILLED CONFORM TO ANSI B16.1 CL 125
- FACE TO FACE DIMENSION CONFORMS TO SERIES 1 OF BS EN 558-1
- SUITABLE MEDIA: WATERS, OIL, AIR & STEAM

Material

No.	DESCRIPTION	MATERIAL	AMERICAN STANDARD
1	Body	Cast Iron	ASTM A 126 B
2	Screen	Stainless Steel	ANSI 304
3	Bonnet	Cast Iron	ASTM A 126 B
4	Gasket	Graphite	Non Asbestos
5	Screw Plug	Brass	ASTM B584 C84400
6	Bolt	Steel	ASTM A 307

G 203

CAST IRON STRAINER, Y TYPE
PN 16 FLANGED

ECI EUROPEAN
CASTING
INDUSTRY

www.ecivalve.it

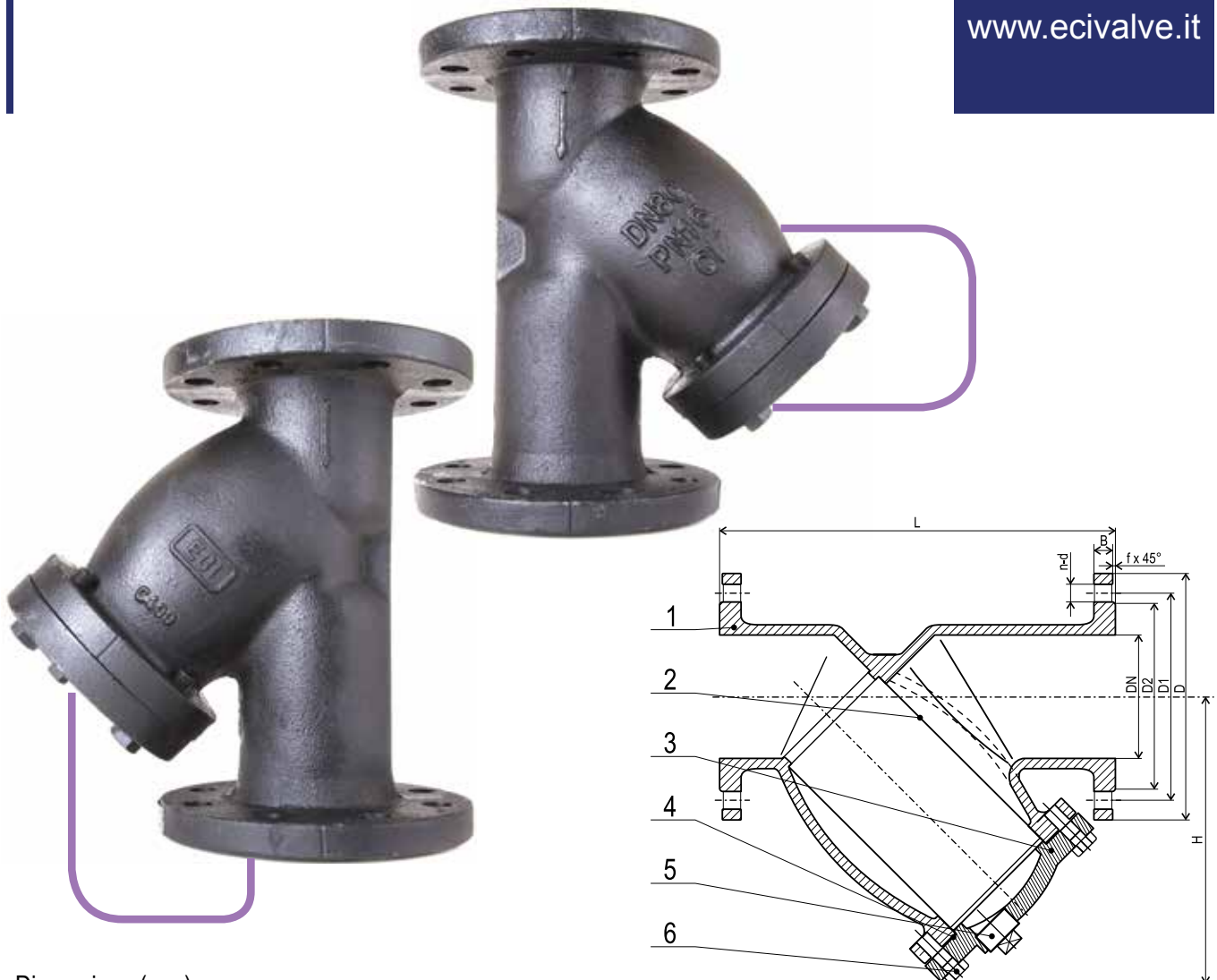

Dimensions (mm)

DN	L	D	D1	D2	B	f	n-d	H	WEIGHT KGS
50	230	165	125	102	20	3	4-19	156	10.9
65	290	185	145	122	20	3	4-19	176	14.5
80	310	200	160	138	22	3	8-19	199	20.9
100	350	220	180	158	24	3	8-19	240	26.8
125	400	250	210	188	26	3	8-19	292	40.2
150	480	285	240	212	26	3	8-23	320	57.1
200	600	340	295	288	30	3	12-23	399	97.1
250	730	405	355	320	32	3	12-28	516	163.0
300	850	460	410	378	32	4	12-28	568	228.4
350	980	520	470	438	36	4	16-28	648	312.0
400	1100	580	525	490	38	4	16-31	759	422.0

Specifications:

- 16 BAR FROM -10 TO 120 °C, 13 BAR AT 220 °C
- FLANGE DRILLED CONFORM TO BS-EN 1092-2 PN 16
- FACE TO FACE DIMENSION CONFORMS TO SERIES 1 OF BS EN 558-1
- SUITABLE MEDIA: WATERS, OIL, AIR & STEAM

Material

No.	DESCRIPTION	MATERIAL	BRITISH STANDARD
1	Body	Cast iron	1561EN JL 1030
2	Screen	Stainless Steel	1449304S315
3	Bonnet	Cast Iron	1561EN JL 1030
4	Gasket	Graphite	Non Asbestos
5	Screw Plug	Brass	Mn Brass
6	Bolt	Steel	BS979 43A

ECI EUROPEAN
CASTING
INDUSTRY

All data, descriptions and pictures contained in this leaflet may be subject to change without prior notice.

European Casting Industry Srl | Via D'Azeglio 57 | 40123 Bologna BO, Italia | P.Iva: 03228761205 | www.ecivalve.it | info@ecivalve.it

G 301

CAST IRON SWING CHECK VALVE

CLASS 125

CONFORMS TO MSS SP-71

ECI EUROPEAN
CASTING
INDUSTRY

www.ecivalve.it

Specifications:

- 125 PSI/8.6 BAR SATURATED STEAM TO 449°F/232°C
200 PSI/13.8 BAR COLD WORKING PRESSURE
FROM -20°F TO 150°F/-29°C TO 66°C
- TEST PRESSURES HYDRAULIC:
BODY: 24 BAR, SEAT: 17.6 BAR
- DESIGN AND MANUFACTURE
CONFORM TO MSS SP-71
- FACE TO FACE DIMENSIONS
CONFORM TO ANSI B16.10
- FLANGE DRILLED CONFORMS
TO ANSI B16.1 CLASS 125
- SUITABLE MEDIA: WATER, OIL, AIR & STEAM
- BOLTED COVER
- SUITABLE FOR MOUNTING IN HORIZONTAL
AND VERTICAL PIPELINES (WITH THE FLOW
UPWARDS OR IN ANY INTERMEDIATE POSTION)

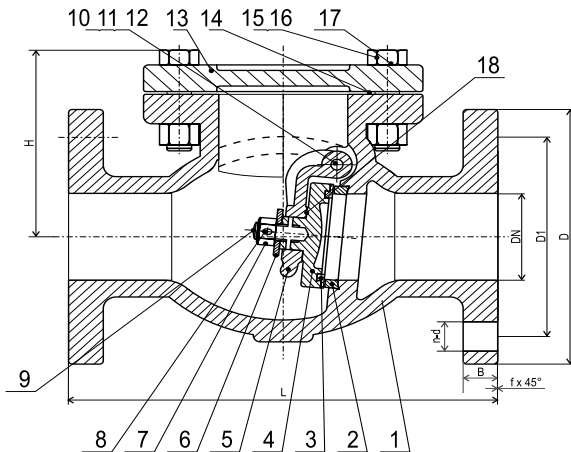

Dimensions (mm)

DN	SIZE INCH	L	D	D1	B	n-d	H	WEIGHT KGS
50	2	203	152	121	15.9	4-19	112	10.4
65	2.1/2	216	178	140	17.5	4-19	132	14.2
80	3	241	190	153	19.0	4-19	141	19.0
100	4	292	229	191	23.8	8-19	162	33.3
125	5	330	254	216	23.8	8-22	192	49.0
150	6	356	279	241	25.4	8-22	211	63.6
200	8	495	343	299	28.6	8-22	270	112.0
250	10	622	406	362	30.2	12-25	316	189.5
300	12	698	483	432	31.8	12-25	357	247.0
350	14	787	533	477	34.9	12-29	560	419
400	16	914	597	540	36.5	16-29	589	542
450	18	914	635	578	39.7	16-32	645	656
500	20	1016	699	635	42.9	20-32	702	832
600	24	1219	813	750	47.6	20-35	812	1260

Material

No.	DESCRIPTION	MATERIAL	AMERICAN STANDARD
1	Body	Cast Iron	ASTM A 126 B
2	Seat Ring	Bronze	ASTM B 62
3	Disc Ring	Bronze	ASTM B 62
4	Disc	Cast Iron	ASTM A 126 B
5	Hanger	Ductile Iron	ASTM A536 60-40-18
6	Washer	Steel	ASTM A 307
7	Nut	Steel	ASTM A 307
8	Split Pin	Stainless Steel	ANSI 304
9	Disc Screw	Steel	ASTM A 307
10	Side Pin	Brass	ASTM B584 C84400
11	Gasket	Soft Steel Cardboard	-
12	Hanger Pin	Stainless Steel	ANSI 304
13	Bonnet	Cast Iron	ASTM A 126 B
14	Gasket	Graphite	Non Asbestos
15	Bolt	Steel	ASTM A 307
16	Nut	Steel	ASTM A 307
17	Identification Plate	Aluminum	-
18	Pin	Stainless Steel	ANSI 304

ECI EUROPEAN
CASTING
INDUSTRY

All data, descriptions and pictures contained in this leaflet may be subject to change without prior notice.

European Casting Industry Srl | Via D'Azeglio 57 | 40123 Bologna BO, Italia | P.Iva: 03228761205 | www.ecivalve.it | info@ecivalve.it

G 303

CAST IRON SWING CHECK VALVE

BS PN 16

CONFORMS TO BS EN 12334:2001

ECI EUROPEAN
CASTING
INDUSTRY

www.ecivalve.it

Specifications:

- **PRESSURE-TEMPERATURE RATING:**
BS EN 1092-2 PN 16
16 BAR FROM -10 TO 120°C
13 BAR AT 220°C
- **TEST PRESSURES HYDRAULIC:**
BODY: 24 BAR, SEAT: 17.6 BAR
- **DESIGN AND MANUFACTURE**
CONFORM TO BS5153 & BS EN 12334:2001
- **FACE TO FACE DIMENSIONS**
CONFORM TO SERIES 10 OF BS EN 558 - 1
- **FLANGE DRILLED CONFORMS**
TO BS EN 1092-2 PN 16
- **SUITABLE MEDIA:** WATER, OIL, AIR & STEAM
- **BOLTED COVER**
- **SUITABLE FOR MOUNTING IN HORIZONTAL AND VERTICAL PIPELINES (WITH THE FLOW UPWARDS OR IN ANY INTERMEDIATE POSITION)**

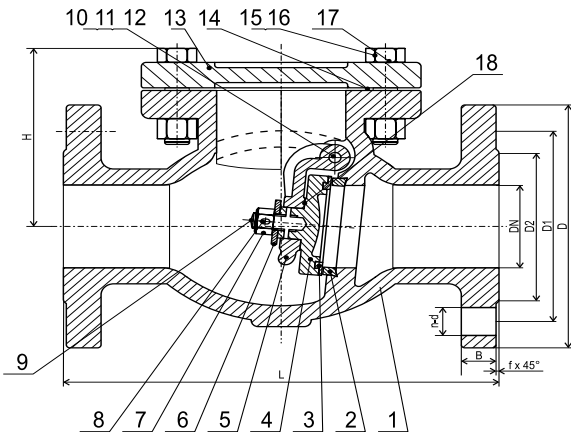

Dimensions (mm)

DN	L	D	D1	D2	B	n-d	f	H	WEIGHT KGS
50	203	165	125	102	20	4-19	3	112	11.2
65	216	185	145	122	20	4-19	3	132	14.4
80	241	200	160	138	22	8-19	3	141	20.0
100	292	220	180	158	24	8-19	3	162	31.5
125	330	250	210	188	26	8-19	3	192	47.0
150	356	285	240	212	26	8-23	3	211	63.5
200	495	340	295	288	30	12-23	3	270	106.4
250	622	405	355	320	32	12-28	3	316	184.5
300	698	460	410	378	32	12-28	4	357	238.5
350	787	520	470	438	36	16-28	4	560	419
400	914	580	525	490	38	16-31	4	589	542
450	914	640	585	550	40	20-31	4	645	656
500	1016	715	650	610	42	20-34	4	702	832
600	1219	840	770	725	48	20-37	5	812	1260

Material

No.	DESCRIPTION	MATERIAL	BRITISH STANDARD
1	Body	Cast Iron	1561 EN JL 1030
2	Seat Ring	Bronze	1982 CC491K
3	Disc Ring	Bronze	1982 CC491K
4	Disc	Cast Iron	1561 EN JL 1030
5	Hanger	Ductile Iron	BS2789 Gr420-12
6	Washer	Steel	BS970 43A
7	Nut	Steel	BS970 43A
8	Split Pin	Stainless Steel	1449 304S315
9	Disc Screw	Steel	BS970 43A
10	Side Pin	Brass	Mn Brass
11	Gasket	Soft Steel Cardboard	-
12	Hanger Pin	Stainless Steel	1449 304S315
13	Bonnet	Cast Iron	1561 EN JL 1030
14	Gasket	Graphite	Non Asbestos
15	Bolt	Steel	BS970 43A
16	Nut	Steel	BS970 43A
17	Identification Plate	Aluminum	-
18	Pin	Stainless Steel	1449 304S315

ECI EUROPEAN
CASTING
INDUSTRY

All data, descriptions and pictures contained in this leaflet may be subject to change without prior notice.

European Casting Industry Srl | Via D'Azeglio 57 | 40123 Bologna BO, Italia | P.Iva: 03228761205 | www.ecivalve.it | info@ecivalve.it

G 311

CAST IRON CHECK VALVE WAFER TYPE

ANSI 125 WP & PN 16

CONFORMS TO MSS SP-125



Specifications:

- PRESSURE RATING ANSI 125
- END CONNECTION SUITABLE FOR FLANGE CONNECTION
ANSI B16.1 125 OR EN 1092-2 PN 16
- USE ONLY FLAT FLANGES AND RING GASKETS
- FACE TO FACE DIMENSIONS CONFORM TO BS EN 558 SERIES 16
- TEMPERATURE OPERATING RANGE -20 TO 120°C
- SUITABLE FOR INSTALLATION IN VERTICAL AND HORIZONTAL PIPELINES
- IN VERTICAL PIPELINES, THE FLOW MUST BE IN AN UPWARD DIRECTION
- NOT SUITABLE FOR STEAM
- SUITABLE MEDIA: WATER, AIR, OIL, ACID AND CORROSIVE MEDIA

Material

No.	DESCRIPTION	MATERIAL	AMERICAN STANDARD
1	Body: Up to 12" 14" to 18"	Cast Iron Ductile Iron	ASTM A 126 B ASTM A536 65-45-12
2	Disc	Stainless Steel	SS304/SS316
3	Liner	EPDM	-
4	Shaft	Stainless Steel	SS410
5	Spring	Stainless Steel	SS316



All data, descriptions and pictures contained in this leaflet may be subject to change without prior notice.

European Casting Industry Srl | Via D'Azeglio 57 | 40123 Bologna BO, Italia | P.Iva: 03228761205 | www.ecivalve.it | info@ecivalve.it

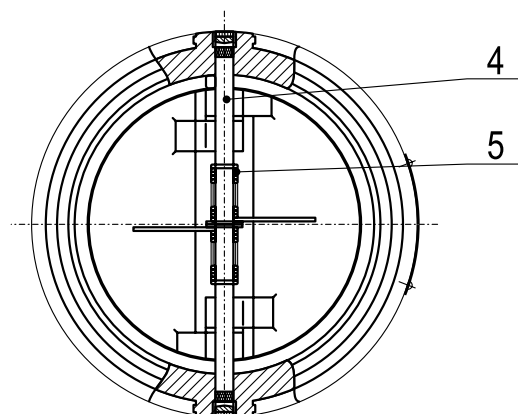
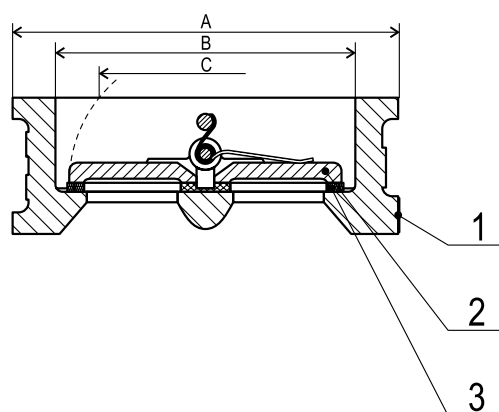
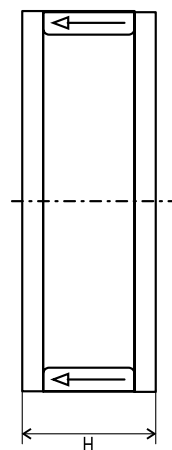

Dimensions (mm)

DN	SIZE INCH	A	B	C	H	WEIGHT KGS
50	2	105	65	42.5	54	1.5
65	2½	124	80	59.9	54	2.0
80	3	137	94	62.6	57	2.8
100	4	175	117	84.2	64	4.1
125	5	197	145	113	70	6.4
150	6	222	170	141	76	8.5
200	8	279	224	194	95	13.5
250	10	340	265	229	108	22.0
300	12	410	310	279	143	30.0
350	14	451	360	312	184	61.0
400	16	514	410	370	191	78.0
450	18	546	450	414	203	100.0

G 401

CAST IRON GLOBE VALVE
ANSI CL 125 FLANGED
OUTSIDE SCREW & YOKE
CONFORMS TO MSS SP-85

ECI EUROPEAN
CASTING
INDUSTRY

www.ecivalve.it

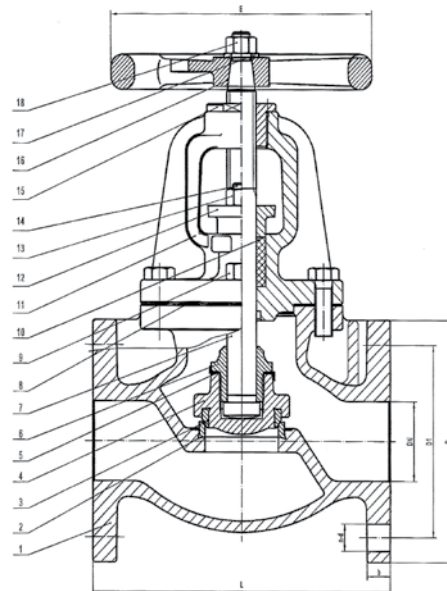
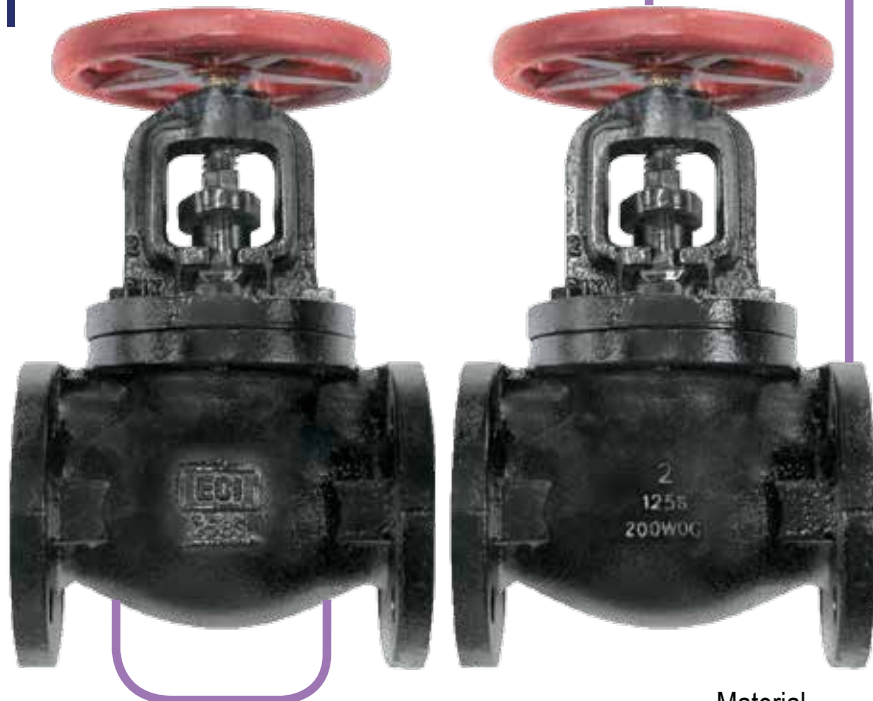

Specifications:

- OUTSIDE SCREW & YOKE
- 125 PSI/8.6 BAR FLUID PRESSURE TO 384°F/230°C
- 200 PSI/13.8 BAR NON-SHOCK COLD WORKING PRESSURE FROM -20°F TO 150°F/ -29°C TO 66°C
- SUITABLE MEDIA: WATER, OIL, AIR & STEAM
- DESIGN AND MANUFACTURE CONFORM TO MSS SP-85
- FACE TO FACE DIMENSIONS CONFORM TO ANSI B16.10
- FLANGE DRILLED CONFORM TO ANSI B16.1 CLASS 125

Dimensions (mm)

DN	INCH	L	D	D1	n-d	B	E	WEIGHT KG
50	2	203	152	121	4-19	15.9	180	15.6
65	2½	216	178	140	4-19	17.5	180	21.5
80	3	241	190	153	4-19	19.1	200	30.9
100	4	292	229	191	8-19	23.9	254	46.8
125	5	330	254	216	8-22	23.9	254	68.4
150	6	356	279	241	8-22	25.4	300	92.6
200	8	495	343	299	8-22	28.6	300	157
250	10	622	406	362	12-25	30.2	350	229
300	12	698	483	432	12-25	31.8	400	318

Material

No.	DESCRIPTION	MATERIAL	AMERICAN STANDARD
1	Body	Cast Iron	ASTM A 126 B
2	Body Seat Ring	Bronze	ASTM B 62
3	Disc Seat Ring	Bronze	ASTM B 62
4	Disc	Cast Iron	ASTM A 126 B
5	Disc Washer	Stainless Steel	ANSI 304
6	Disc Nut	Stainless Steel	ANSI 304
7	Stem	Stainless Steel	ANSI 304
8	Gasket	Graphite	Non Asbestos
9	Bolt	Steel	ASTM A 307
10	Packing	Graphite	Non Asbestos
11	Bonnet	Cast Iron	ASTM A 126 B
12	Gland Flange	Ductile Iron	ASTM A536 60-40-18
13	Nut	Steel	ASTM A 307
14	Bolt	Steel	ASTM A 307
15	Stem Nut	Brass	ASTM B584 C84400
16	Handwheel	Cast Iron	ASTM A 126 B
17	Handwheel Washer	Steel	ASTM A 307
18	Handwheel Nut	Steel	ASTM A 307

ECI EUROPEAN
CASTING
INDUSTRY

All data, descriptions and pictures contained in this leaflet may be subject to change without prior notice.

European Casting Industry Srl | Via D'Azeglio 57 | 40123 Bologna BO, Italia | P.Iva: 03228761205 | www.ecivalve.it | info@ecivalve.it

G 403

CAST IRON GLOBE VALVE

BS PN 16 FLANGED

RISING STEM

CONFORMS TO BS EN 13789:2010

ECI EUROPEAN
CASTING
INDUSTRY

www.ecivalve.it

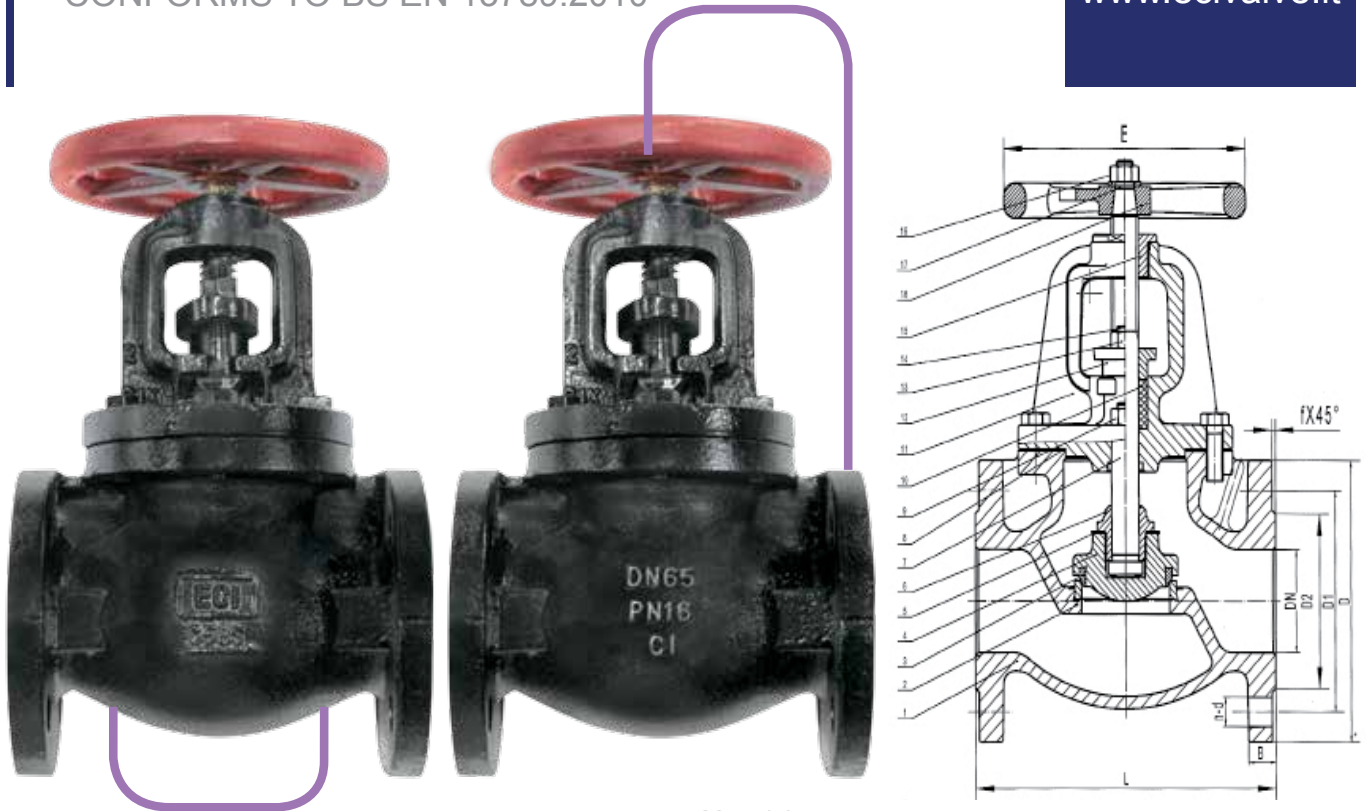

Specifications:

- OUTSIDE SCREW & YOKE
- PRESSURE-TEMPERATURE RATING: 16 BAR AT -10 TO 120°C
12.1 BAR AT 230°C
- TEST PRESSURES HYDRAULIC: SHELL: 24 BAR, SEAT: 17.6 BAR
- DESIGN AND MANUFACTURE CONFORM TO BS5152
(BS EN 13789:2010 PN16)
- FACE TO FACE DIMENSIONS CONFORM TO SERIES 10 OF BS EN 558-1
- FLANGE DRILLED CONFORM TO BS EN 1092-2 PN 16
- GATE VALVES ARE DESIGNED TO BE IN AN OPEN OR CLOSED POSITION
- SUITABLE MEDIA: WATER, OIL, AIR & STEAM

Dimensions (mm)

DN	L	D	D1	D2	n-d	B	f	E	WEIGHT KGS
50	203	165	125	102	4-19	20	3	180	16.4
65	216	185	145	122	4-19	20	3	180	22.0
80	241	200	160	138	8-19	22	3	200	31.5
100	292	220	180	158	8-19	24	3	254	46.0
125	330	250	210	188	8-19	26	3	254	68.7
150	356	285	240	212	8-23	26	3	300	92.8
200	495	340	295	288	12-23	30	3	300	157
250	622	405	355	320	12-28	32	3	350	228
300	698	460	410	378	12-28	32	4	400	313

Material

No.	DESCRIPTION	MATERIAL	BRITISH STANDARD
1	Body	Cast Iron	1561 EN JL 1030
2	Body Seat Ring	Bronze	1982 CC 491K
3	Disc Seat Ring	Bronze	1982 CC 491K
4	Disc	Cast Iron	1561 EN JL 1030
5	Disc Washer	Stainless Steel	1449 304S315
6	Nut	Brass	12164 CW603R
7	Stem	Stainless Steel	1449 304S315
8	Flange Gasket	Graphite	Non Asbestos
9	Bolt	Steel	BS970 43A
10	Packing	Graphite	Non Asbestos
11	Bonnet	Cast Iron	1561 EN JL 1030
12	Gland	Ductile Iron	BS2789 Gr.420-12
13	Nut	Steel	BS970 43A
14	Bolt	Steel	BS970 43A
15	Stem	Brass	12164 CW603R
16	Handwheel	Cast Iron	1561 EN JL 1030
17	Handwheel Washer	Steel	BS970 43A
18	Handwheel Nut	Steel	BS970 43A

ECI EUROPEAN
CASTING
INDUSTRY

All data, descriptions and pictures contained in this leaflet may be subject to change without prior notice.

European Casting Industry Srl | Via D'Azeglio 57 | 40123 Bologna BO, Italia | P.Iva: 03228761205 | www.ecivalve.it | info@ecivalve.it

G 501

CAST IRON GATE VALVE
ANSI CL 125 FLANGED
NON-RISING STEM
CONFORMS TO MSS SP-70

ECI EUROPEAN
CASTING
INDUSTRY

www.ecivalve.it

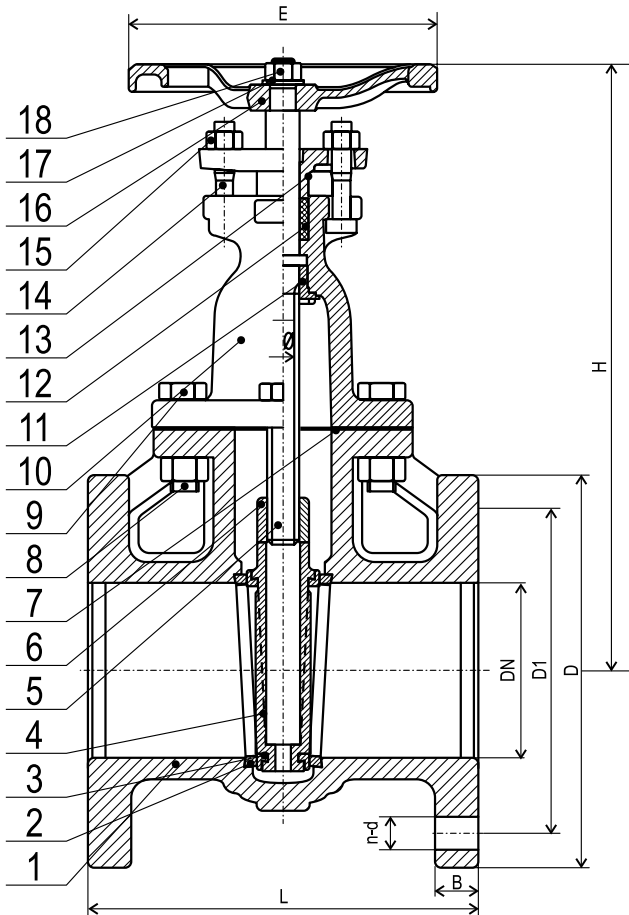

Specifications:

- INSIDE SCREW NON-RISING STEM
- 125 PSI/8.6 BAR FLUID PRESSURE TO 353°F/178°C
- 200 PSI/13.8 BAR NON-SHOCK COLD WORKING PRESSURE FROM -20°F TO 150°F/ -29°C TO 66°C
- SUITABLE MEDIA: WATER, OIL, AIR & STEAM
- DESIGN AND MANUFACTURE CONFORM TO MSS SP-70
- FACE TO FACE DIMENSIONS CONFORM TO ANSI B16.10
- FLANGE DRILLED CONFORM TO ANSI B16.1 CLASS 125
- GATE VALVES ARE DESIGNED TO BE IN AN OPEN OR CLOSED POSITION

Material

No.	DESCRIPTION	MATERIAL	AMERICAN STANDARD
1	Body	Cast Iron	ASTM A 126 B
2	Body Seat Ring	Bronze	ASTM B 62
3	Wedge Seat Ring	Bronze	ASTM B 62
4	Wedge	Cast Iron	ASTM A 126 B
5	Stem	Brass	ASTM B 16
6	Stem Nut	Brass	ASTM B584 C84400
7	Gasket	Graphite	Non Asbestos
8	Bolt	Steel	ASTM A 307
9	Nut	Steel	ASTM A 307
10	Bonnet	Cast Iron	ASTM A 126 B
11	Bonnet Bush	Brass	ASTM B584 C84400
12	Packing	Graphite	Non Asbestos
13	Gland Follower	Ductile Iron	ASTM A536 60-40-18
14	Bolt	Steel	ASTM A 307
15	Nut	Steel	ASTM A 307
16	Handwheel	Cast Iron	ASTM A 126 B
17	Washer	Steel	ASTM A 307
18	Handwheel Nut	Steel	ASTM A 307

Dimensions (mm)

DN	SIZE INCH	L	D	D1	n-d	B	E	H	WEIGHT KG
50	2	178	152	121	4-19	15.9	180	240	12.0
65	2½	190	178	140	4-19	17.5	180	265	15.4
80	3	203	190	153	4-19	19.1	200	323	22.6
100	4	229	229	191	8-19	23.9	254	365	35.8
125	5	254	254	216	8-22	23.9	254	413	47.6
150	6	267	279	241	8-22	25.4	300	477	63.0
200	8	292	343	299	8-22	28.6	300	585	106
250	10	330	406	362	12-25	30.2	350	710	168
300	12	356	483	432	12-25	31.8	400	789	243

ECI EUROPEAN
CASTING
INDUSTRY

All data, descriptions and pictures contained in this leaflet may be subject to change without prior notice.

European Casting Industry Srl | Via D'Azeglio 57 | 40123 Bologna BO, Italia | P.Iva: 03228761205 | www.ecivalve.it | info@ecivalve.it

G 503

CAST IRON GATE VALVE

BS PN 16 FLANGED

NON-RISING STEM

CONFORMS TO BS EN 1171:2002 PN 16

ECI EUROPEAN
CASTING
INDUSTRY

www.ecivalve.it

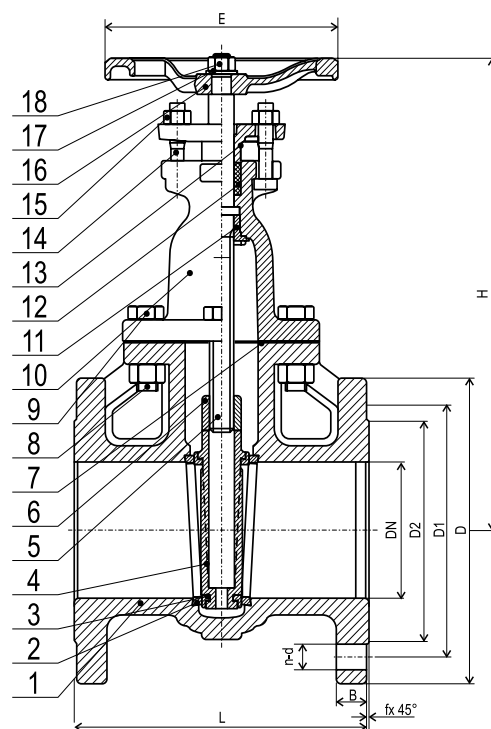

Specifications:

- PRESSURE-TEMPERATURE RATING: 16 BAR AT -10 TO 120°C
12.8 BAR AT 200°C
- TEST PRESSURES HYDRAULIC: SHELL: 24 BAR, SEAT: 17.6 BAR
- DESIGN AND MANUFACTURE CONFORM TO BS5150
(BS EN 1171:2002 PN 16)
- FACE TO FACE DIMENSIONS CONFORM TO SERIES 3 OF BS EN 558-1
- FLANGE DRILLED CONFORM TO BS EN 1092-2 PN 16
- GATE VALVES ARE DESIGNED TO BE IN AN OPEN OR CLOSED POSITION
- SUITABLE MEDIA: WATER, OIL, AIR & STEAM

Dimensions (mm)

DN	L	D	D1	D2	n-d	B	f	E	H	WEIGHT KGS
50	178	165	125	102	4-19	20	3	180	240	13.5
65	190	185	145	122	4-19	20	3	180	265	16.7
80	203	200	160	138	8-19	22	3	200	323	23.3
100	229	220	180	158	8-19	24	3	254	365	35.9
125	254	250	210	188	8-19	26	3	254	413	48.5
150	267	285	240	212	8-23	26	3	300	477	66.5
200	292	340	295	288	12-23	30	3	300	585	102
250	330	405	355	320	12-28	32	3	350	710	174
300	356	460	410	378	12-28	32	4	400	789	230

Material

No.	DESCRIPTION	MATERIAL	BRITISH STANDARD
1	Body	Cast iron	1561 EN JL 1030
2	Body Seat Ring	Bronze	1982 CC 491K
3	Wedge Seat Ring	Bronze	1982 CC 491K
4	Wedge	Cast Iron	1561 EN JL 1030
5	Stem	Brass	12164 CW603R
6	Stem Nut	Brass	Mn Brass
7	Gasket	Graphite	Non Asbestos
8	Bolt	Steel	BS970 43A
9	Nut	Steel	BS970 43A
10	Bonnet	Cast Iron	1561 EN JL 1030
11	Bonnet Bush	Brass	Mn Brass
12	Packing	Graphite	Non Asbestos
13	Gland Follower	Ductile Iron	BS2789 Gr.420-12
14	Bolt	Steel	BS970 43A
15	Nut	Steel	BS970 43A
16	Handwheel	Cast Iron	1561 EN JL 1030
17	Handwheel Washer	Steel	BS970 43A
18	Handwheel Nut	Steel	BS970 43A

ECI EUROPEAN
CASTING
INDUSTRY

All data, descriptions and pictures contained in this leaflet may be subject to change without prior notice.

European Casting Industry Srl | Via D'Azeglio 57 | 40123 Bologna BO, Italia | P.Iva: 03228761205 | www.ecivalve.it | info@ecivalve.it

G 505

CAST IRON GATE VALVE

ANSI CL 125 FLANGED

RISING STEM

CONFORMS TO MSS SP-70

ECI EUROPEAN
CASTING
INDUSTRY

www.ecivalve.it

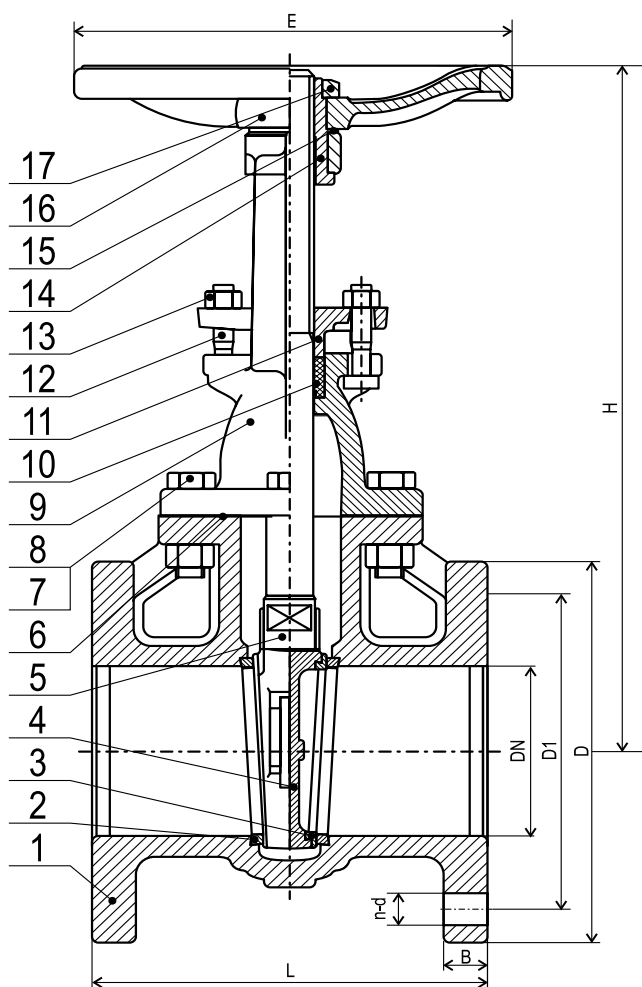

Specifications:

- OUTSIDE SCREW & YOKE
- 125 PSI/8.6 BAR FLUID PRESSURE TO 353°F/178°C
- 200 PSI/13.8 BAR NON-SHOCK COLD WORKING PRESSURE FROM -20°F TO 150°F/ -29°C TO 66°C
- TEST PRESSURE SHELL 24.1 BAR & SEAT 13.8 BAR
- SUITABLE MEDIUM: WATER, OIL, AIR & STEAM
- DESIGN AND MANUFACTURE CONFORM TO MSS SP-70
- FACE TO FACE DIMENSIONS CONFORM TO ANSI B16.10
- FLANGE DIMENSIONS CONFORM TO ANSI B16.1 CLASS 125
- GATE VALVES ARE DESIGNED TO BE IN AN OPEN OR CLOSED POSITION

Material

No.	DESCRIPTION	MATERIAL	AMERICAN STANDARD
1	Body	Cast iron	ASTM A 126 B
2	Body Seat Ring	Bronze	ASTM B 62
3	Wedge Seat Ring	Bronze	ASTM B 62
4	Wedge	Cast Iron	ASTM A 126 B
5	Stem	Brass	ASTM B 16
6	Gasket	Graphite	Non-Asbestos
7	Bolt	Steel	ASTM 307
8	Nut	Steel	ASTM 307
9	Bonnet	Cast Iron	ASTM A 126 B
10	Packing	Graphite	Non-Asbestos
11	Gland Follower	Ductile Iron	ASTM A536 60-40-18
12	Bolt	Steel	ASTM 307
13	Nut	Steel	ASTM 307
14	Stem Nut	Brass	ASTM B584 C884400
15	Handwheel Washer	Brass	ASTM B584 C884400
16	Handwheel	Cast Iron	ASTM A 126 B
17	Handwheel Nut	Steel	ASTM 307

Dimensions (mm)

DN	SIZE INCH	L	D	D1	n-d	B	E	H CLOSED	Weight KG
50	2	178	152	121	4-19	15.9	180	258	13.1
65	2½	190	178	140	4-19	17.5	180	302	17.4
80	3	203	190	153	4-19	19.1	200	341	22.8
100	4	229	229	191	8-19	23.9	254	415	37.5
125	5	254	254	216	8-22	23.9	254	484	48.0
150	6	267	279	241	8-22	25.4	300	560	64.7
200	8	292	343	299	8-22	28.6	300	703	106.0
250	10	330	406	362	12-25	30.2	350	865	178.2
300	12	356	483	432	12-25	31.8	400	1028	266.9

ECI EUROPEAN
CASTING
INDUSTRY

All data, descriptions and pictures contained in this leaflet may be subject to change without prior notice.

European Casting Industry Srl | Via D'Azeglio 57 | 40123 Bologna BO, Italia | P.Iva: 03228761205 | www.ecivalve.it | info@ecivalve.it

G 507

CAST IRON GATE VALVE

PN 16 FLANGED

RISING STEM

CONFORMS TO BS EN 1171:2002 PN 16

ECI EUROPEAN
CASTING
INDUSTRY

www.ecivalve.it

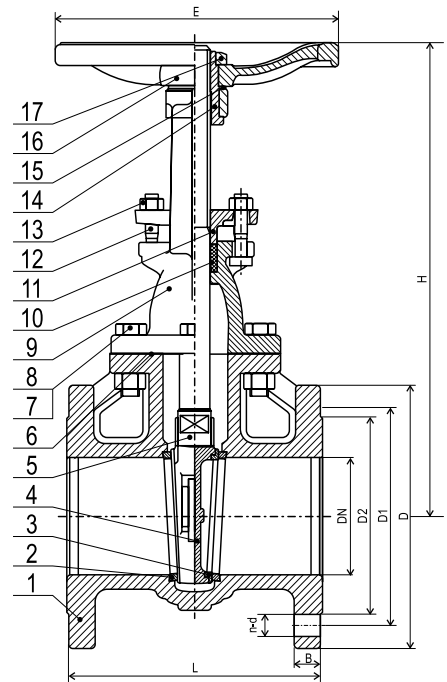

Specifications:

- OUTSIDE SCREW & YOKE
- PRESSURE-TEMPERATURE RATING: 16 BAR AT -10 TO 120°C
12.8 BAR AT 200°C
- TEST PRESSURES HYDRAULIC: SHELL: 24 BAR, SEAT: 17.6 BAR
- DESIGN AND MANUFACTURE CONFORM TO BS5150
(BS EN 1171:2002 PN 16)
- FACE TO FACE DIMENSIONS CONFORM TO SERIES 3 OF BS EN 558-1
- FLANGE DRILLED CONFORM TO BS EN 1092-2 PN 16
- GATE VALVES ARE DESIGNED TO BE IN AN OPEN OR CLOSED POSITION
- SUITABLE MEDIA: WATER, OIL, AIR & STEAM

Dimensions (mm)

DN	L	D	D1	D2	n-d	B	f	E	H CLOSED	WEIGHT KGS
50	178	165	125	102	4-19	20	3	180	240	14.1
65	190	185	145	122	4-19	20	3	180	265	18.2
80	203	200	160	138	8-19	22	3	200	323	23.8
100	229	220	180	158	8-19	24	3	254	365	36.1
125	254	250	210	188	8-19	26	3	254	413	48.9
150	267	285	240	212	8-23	26	3	300	477	66.3
200	292	340	295	288	12-23	30	3	300	585	102
250	330	405	355	320	12-28	32	3	350	710	184
300	356	460	410	378	12-28	32	4	400	789	254

Material

No.	DESCRIPTION	MATERIAL	BRITISH STANDARD
1	Body	Cast Iron	1561 EN JL 1030
2	Body Seat Ring	Bronze	1982 CC 491K
3	Wedge Seat Ring	Bronze	1982 CC 491K
4	Wedge	Cast Iron	1561 EN JL 1030
5	Stem	Brass	12164 CW603R
6	Gasket	Graphite	Non Asbestos
7	Bolt	Steel	Steel
8	Nut	Steel	Steel
9	Bonnet	Cast Iron	1561 EN JL 1030
10	Packing	Graphite	Non Asbestos
11	Gland Follower	Ductile Iron	ASTM A536 60-40-18
12	Bolt	Steel	Steel
13	Nut	Steel	Steel
14	Stem Nut	Brass	Mn Brass
15	Handwheel Washer	Brass	Mn Brass
16	Handwheel	Cast Iron	1561 EN JL 1030
17	Handwheel Nut	Steel	Steel

ECI EUROPEAN
CASTING
INDUSTRY

All data, descriptions and pictures contained in this leaflet may be subject to change without prior notice.

European Casting Industry Srl | Via D'Azeglio 57 | 40123 Bologna BO, Italia | P.Iva: 03228761205 | www.ecivalve.it | info@ecivalve.it

G 801

CAST IRON BALANCING VALVE
 VARIABLE ORIFICE DOUBLE REGULATING VALVE (VODRV)
 FLANGED TO CLASS 125 = G801-CL.125
 FLANGED TO PN 16 = G801-PN 16
 CONFORM TO BS 7350 PN 16



www.ecivalve.it

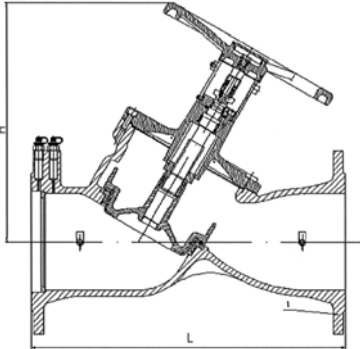

Specifications:

- Y PATTERN GLOBE VALVE SUPPLIED WITH TWO TEST POINTS
- PROVIDE FLOW MEASUREMENT & REGULATION
- TO BE USED FOR ISOLATING & TO BE REOPENED TO IT'S PRE-SET POSITION
- ACCURACY $\pm 5\%$ ON ALL SETTING
- DESIGN & MANUFACTURE CONFORM TO BS 7350 PN 16
- SUITABLE MEDIUM: WATER
- WORKING TEMPERATURE: $T \leq 120^{\circ}\text{C}$



Pressure / Temperature Ratings

TEMPERATURE ($^{\circ}\text{C}$)	PRESSURE (BAR)
-10 to 120	16.0

Ratings align with BS EN 1092-2 PN16 (formerly BS 4504) or CL 125

Dimensions (mm)

DN	FACE TO FACE L (mm)	CENTRE-TO-TOP H (mm)	WEIGHT KGS
65	290	299	15.8
80	310	306	19.5
100	350	332	28.0
125	400	361	37.5
150	480	371	50.5
200	600	542	123
250	730	583	192
300	850	685	251

Coefficients

DN	FLOW (Kv)	HEADLOSS (K)
65	85	4.9
80	111	5.5
100	146	9.2
125	250	7.3
150	380	6.5
200	600	7.8
250	1211	4.6
300	1521	6.0

*Fully open position.

Material

PART NAME	MATERIAL	BRITISH STANDARD
Body	Ductile Iron	BS2789 GR.420-12
Bonnet	Ductile Iron	BS2789 GR.420-12
Bonnet Gasket	Graphite	Non Asbestos
Disc (All Sizes)	Cast Iron EPDM Coated	1561EN JL 1030
Disch Bush	Bronze	1982 CC 491K
Stem	Stainless Steel	SS 410
Gland	Stainless Steel	SS 304
Memory Stop	Stainless Steel	SS 304
Gland Nut	Steel	BS970 43A
Indicator Set	Stainless Steel	SS 304
Indicator Finger	Bronze	1982 CC 491K



All data, descriptions and pictures contained in this leaflet may be subject to change without prior notice.

European Casting Industry Srl | Via D'Azeglio 57 | 40123 Bologna BO, Italia | P.Iva: 03228761205 | www.ecivalve.it | info@ecivalve.it



Manaraat Al Maarifa Project in Jeddah, Saudi Arabia

Project awarded - September, 2016